

SIGN A	24" Mattress Firm linear
Type:	Individual Channel letters/ Remote Wired
Illumination:	Internally Illuminated LED
Square Footage:	24" x 247.25" = 41.20 sq ft

SIGN B	24" Mattress Firm linear
Type:	Individual Channel letters/ Remote Wired
Illumination:	Internally Illuminated LED
Square Footage:	24" x 247.25" = 41.20 sq ft

SIGN C	Mattress Firm - RTA Vinyl
Type:	Ready-to-Appl Vinyl Graphics on existing Tenant Panel
Square Footage:	1.78

BLD-2021-0418 was approved with Sign A.

sign exception request is for the Sign B which is facing the Chevron/S. De Anza Blvd

LOT AREA 139,940 SQ FT  
BUILDING AREA 4200 SQ FT

The building is setback 30' from Stevens Creek Blvd to the north ,  
141' from the east property line,  
24' from the west property line,  
and 340 ft from the south property line

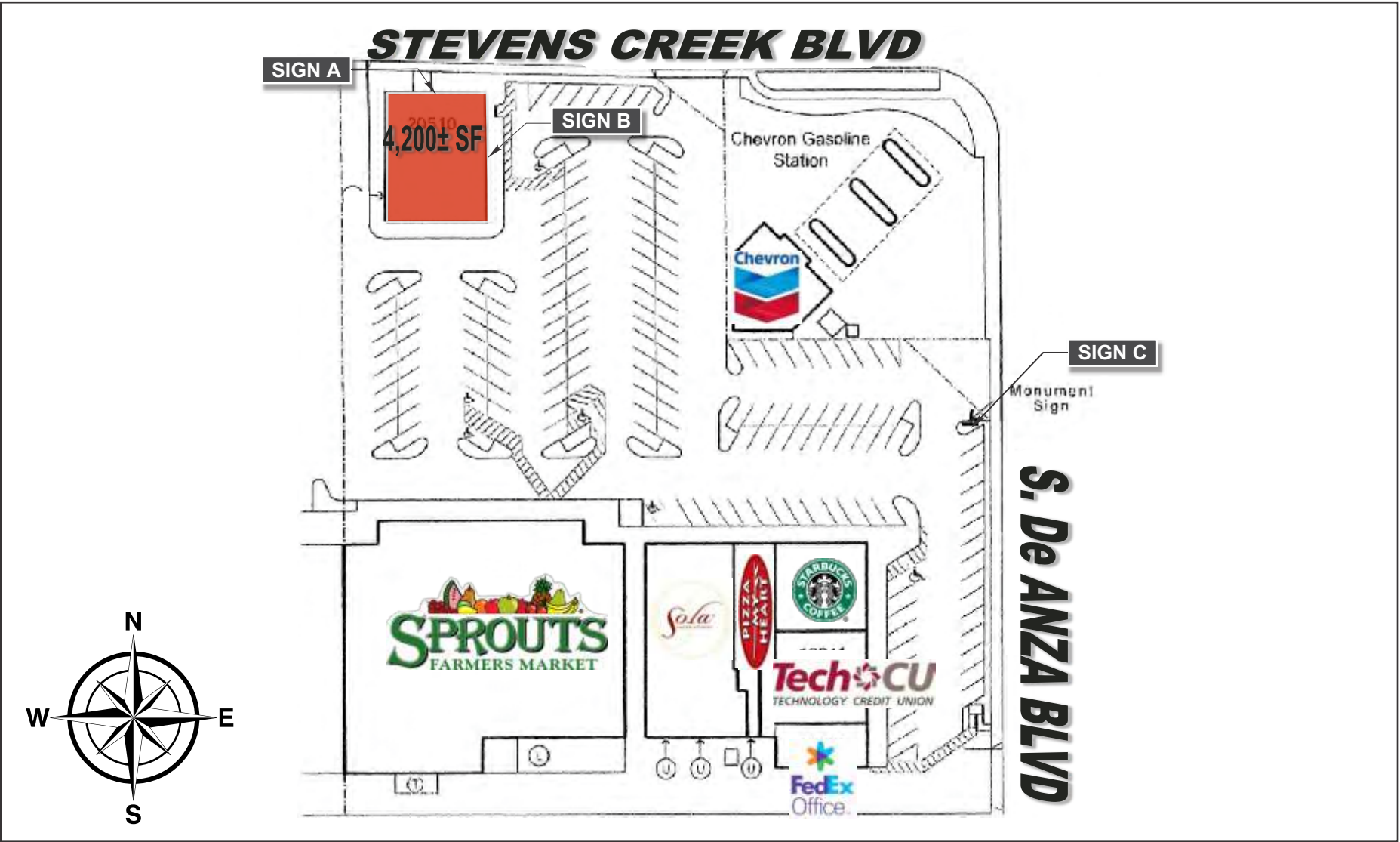
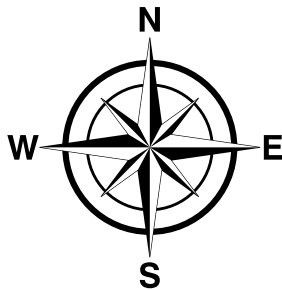

SIGN A	24" Mattress Firm linear
Type:	Individual Channel letters/ Remote Wired
Illumination:	Internally Illuminated LED
Square Footage:	24" x 247.25" = 41.20 sq ft

The illumination intensity of signs located within commercial areas is not to exceed approximately 250 foot-lambers, see Cupertino Municipal Code (CMC) Section 19.104.230 (A)



Existing



Front Elevation (North)  
Scale: 1/8" = 1'-0"

NOTE: DRAWING IS FOR REPRESENTATIONAL PURPOSES ONLY. EXACT DIMENSIONS (FIELD SURVEY) REQUIRED PRIOR TO FABRICATION	Allowable Square Footage this Elevation:	87.48
	Formula: 200.00 SqFt Aggregate for entire site	
	Actual Square Footage this Elevation:	57.52

<b>SIGN A</b>	24" Mattress Firm linear
<b>Type:</b>	Individual Channel letters/ Remote Wired
<b>Illumination:</b>	Internally Illuminated LED
<b>Square Footage:</b>	24" x 247.25" = 41.20 sq ft

<b>SIGN B</b>	24" Mattress Firm linear
<b>Type:</b>	Individual Channel letters/ Remote Wired
<b>Illumination:</b>	Internally Illuminated LED
<b>Square Footage:</b>	24" x 247.25" = 41.20 sq ft

The illumination intensity of signs located within commercial areas is not to exceed approximately 250 foot-lambers, see Cupertino Municipal Code (CMC) Section 19.104.230 (A)



Sign Layout Detail  
Scale: 3/8" = 1'-0"

Electrical Detail:

White LEDs  
(X) 60w Power Supplies @ 0.85 amps each  
Total Amps: X.XX  
(1) 20 amp 120V Circuit Req.



General Notes:

- This sign is to be installed in accordance with the requirements of Article 600 of the National Electrical Code.
- Grounded and bonded per NEC 600.7/NEC 250
  - Existing branch circuit in compliance with NEC 600.5, not to exceed 20 amps
  - Sign is to be UL listed per NEC 600.3
  - UL disconnect switch per NEC 600.6- required per sign component before leaving manufacturer. For multiple signs, a disconnect is permitted but not required for each section
  - The location of the disconnect switch after installation shall comply with article 600.6 (A) (1) per NEC

Specifications: Channel Letters on backer panel

1. Existing Facade: To be determined
2. 0.040" Aluminum letter returns painted to match Dark Brown
3. 1"Jewelrite trimcap (Dark Brown) bonded to face, #8 pan head screws to returns
4. .125" ACM backs (pre-finished white) fastened to returns. Seal w/ VOC compliant 360 white latex caulk to prevent moisture penetration.
5. GE Tetra Powermax LEDs (Red)
6. 3/16" Red acrylic faces
7. Disconnect switch UL Outdoor rated toggle type w/ neoprene boot per NEC 600-6
8. Primary electrical feed in UL conduit / customer supplied UL junction box
9. Power Supplies within UL enclosure (removable lid), 1/4" x 1" min screws
10. Mounting Hardware to suit
11. 0.080 Aluminum backer panel painted Black

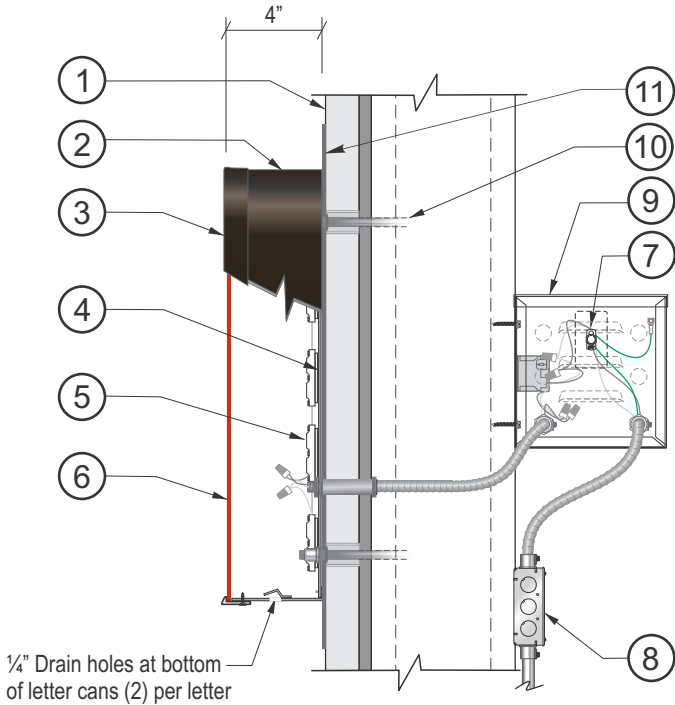

Section @ LED Channel Letter  
Front-Lit (Remote)  
Scale: N.T.S.



This rendering is the property of Apex Sign Group. It is for the exclusive use of Apex Sign Group and the party for which it was intended, the requestor. It is an unpublished original drawing not to be distributed, reproduced, or exhibited without the explicit consent of Apex Sign Group. Please contact your account manager for questions regarding this statement.

apexsigngroup.com

**Mattress Firm**  
20510 Stevens Creek Blvd.  
Cupertino CA 95014

Project ID#: **125607**  
Project Mgr: Cheryl Roberts  
Designer: Mike DeMarco  
Created on: 10/29/2020

REVISION	R3	12/11/20	KF - Updated Cl's to red no backer for all elevations
	R4	01/06/20	KF - Changed Signs back to white on backer for all elevations
	R5	01/25/21	KF - Modified Sign B for Parapet mounting, updated Monument specifications
	R6	02/05/21	KF - Updated package to reflect latest feedback from client & LL
	R7	02/08/21	KF - Updated variance notes, updated photo for Side Elevation
	R8	02/12/21	KF - Update City & LL code information, added note on monument page



SIGN B	24" Mattress Firm linear
Type:	Individual Channel letters/ Remote Wired
Illumination:	Internally Illuminated LED
Square Footage:	24" x 247.25" = 41.20 sq ft



Existing



Side Elevation (East)

Scale: 1/8" = 1'-0"

NOTE: DRAWING IS FOR REPRESENTATIONAL PURPOSES ONLY. EXACT DIMENSIONS (FIELD SURVEY) REQUIRED PRIOR TO FABRICATION	Allowable Square Footage this Elevation:	87.48
	Formula: 200.00 SqFt Aggregate for entire site	
	Actual Square Footage this Elevation:	57.52