



## DESIGN PROFESSIONAL SERVICES AGREEMENT (SINGLE) WITH CSG CONSULTANTS, INC.

### 1. **PARTIES**

This Agreement is made by and between the City of Cupertino, a municipal corporation (“City”), and CSG Consultants, Inc. (“Consultant”), a Corporation for Building plan review services for the Valco Town Center project (“Project”), and is effective on the last date signed below (“Effective Date”).

### 2. **SERVICES**

Contractor agrees to provide the services and perform the tasks (“Services”) set forth in detail in Scope of Services, attached here and incorporated as **Exhibit A**.

### 3. **TIME OF PERFORMANCE**

**3.1 Term.** This Agreement begins on the Effective Date and ends on June 30, 2023, unless terminated earlier as provided herein (“Contract Time”). The City’s appropriate department head or City Manager may extend the Contract Time through a written amendment to this Agreement, provided such extension does not include additional contract funds. Extensions requiring additional contract funds are subject to the City’s purchasing policy.

**3.2 Schedule of Performance.** All Services must be provided within the times specified in **Exhibit B**, Schedule of Performance, attached and incorporated here. Consultant must promptly notify City of any actual or potential delay in providing the Services as scheduled to afford the Parties adequate opportunity to address or mitigate delays. If the Services are divided by tasks, Consultant must begin work on each separate task upon receiving City’s Notice to Proceed (“NTP”), and must complete each task within the time specified in **Exhibit B**.

**3.3 Time is of the essence** for the performance of all the Services. Consultant must have sufficient time, resources, and qualified staff to deliver the Services on time.

### 4. **COMPENSATION**

**4.1 Maximum Compensation.** City will pay Contractor for satisfactory performance of the Services an amount that will be based on actual costs but that will be capped so as not to exceed \$1,150,000 (“Contract Price”), based upon the scope of services in **Exhibit A** and the budget and rates included in **Exhibit C**, Compensation attached and incorporated here. The maximum compensation includes all expenses and reimbursements and will remain in place even if Contractor’s actual costs exceed the capped amount. No extra work or payment is permitted without prior written approval of City.

**4.2 Invoices and Payments.** Monthly invoices must state a description of the deliverable completed and the amount due for the preceding month. Within thirty (30) days of completion of Services, Contractor must submit a requisition for final and complete payment of costs and pending claims for City approval. Failure to timely submit a complete and accurate payment requisition relieves City of any

further payment or other obligations under the Agreement.

## **5. INDEPENDENT CONTRACTOR**

**5.1 Status.** Consultant is an independent Consultant and not an employee, partner, or joint venture of the City. Consultant is solely responsible for the means and methods of performing the Services and shall exercise full control over the employment, direction, compensation and discharge of all persons assisting Consultant in performing the Services. Consultant is not entitled to health benefits, worker's compensation, retirement, or any City benefit.

**5.2 Qualifications and Standard of Care.** Consultant represents on behalf of itself and its sub-Consultants that they have the qualifications and skills to perform the Services in a competent and professional manner, as exercised by design professionals performing similar services in the San Francisco Bay Area. Services may only be performed by qualified and experienced personnel or subconsultants who are not employed by City and do not have any contractual relationship with City excepting this Agreement. All Services must be performed as specified to City's reasonable satisfaction.

**5.3 Permits and Licenses.** Consultant warrants on behalf of itself and any sub-Consultants that they are properly licensed, registered, and/or certified to perform the Services, as required by law, and that they have procured a valid City Business License, if required by the Cupertino Municipal Code.

**5.4 Sub-Consultants.** Unless prior written approval from City is obtained, only Consultant's employees and sub-Consultants whose names are included in this Agreement and incorporated Exhibits may provide Services under this Agreement. Consultant must require all sub-Consultants to furnish proof of insurance for workers' compensation, commercial liability, auto, and professional liability in reasonable conformity to the insurance required of Consultant. The terms and conditions of this Agreement shall be binding on all sub-Consultants relative to the portion of their work.

**5.5 Tools, Materials, and Equipment.** Consultant will supply and shall be responsible for all tools, materials, and equipment required to perform the Services under this Agreement.

**5.6 Payment of Benefits and Taxes.** Consultant is solely responsible for the payment of employment taxes incurred under this Agreement and any similar federal or state taxes. Consultant and any of its employees, agents, and subcontractors shall not have any claim under this Agreement or otherwise against City for seniority, vacation time, vacation pay, sick leave, personal time off, overtime, health insurance, medical care, hospital care, insurance benefits, social security, disability, unemployment, workers compensation or employee benefits of any kind. Consultant shall be solely liable for and obligated to pay directly all applicable taxes, fees, contributions, or charges applicable to Consultant's business including, but not limited to, federal and state income taxes. City shall have no obligation whatsoever to pay or withhold any taxes or benefits on behalf of Consultant. Should any court, arbitrator, or administrative authority, including but not limited to the California Public Employees Retirement System (PERS), the Internal Revenue Service or the State Employment Development Division, determine that Consultant, or any of its employees, agents, or subcontractors, is an employee for any purpose, then Consultant agrees to a reduction in amounts payable under this Agreement, or to promptly remit to City any payments due by the City as a result of such determination, so that the City's total expenses under this Agreement are not greater than they would have been had the determination not been made. This Section 5.6 survives the expiration/termination of this Agreement.

**5.7 Errors and Omissions.** Consultant is solely responsible for its errors and omissions and those of its sub-Consultants, and must take prompt measures to avoid, mitigate, and correct them at its sole expense.

## **6. PROPRIETARY/CONFIDENTIAL INFORMATION**

During the Contract Time, Consultant may have access to private or confidential information owned or controlled by the City, which may contain proprietary or confidential details, the disclosure of which to third parties may be damaging to City. Consultant shall hold in confidence all City information and use it only to perform this Agreement. Consultant shall exercise the same standard of care to protect City information as a reasonably prudent Consultant would use to protect its own proprietary data.

## **7. OWNERSHIP OF MATERIALS**

**7.1 Property Rights.** Subject to City meeting its payment obligations for the Services, any interest (including copyright interests) of Consultant in any product, memoranda, study, report, map, plan, drawing, specification, data, record, document, or other information or work, in any medium, prepared by Consultant under this Agreement (“Work Product”), will be the exclusive property of the City upon completion of the work to be performed hereunder or upon termination of this Agreement, to the extent requested by City. In any case, no Work Product shall be shown to a third-party without prior written approval by City

**7.2 Copyright.** To the extent permitted by Title 17 of the U.S. Code, all copyrights to the Work Product prepared/created by Consultant and its sub-Consultants and all copyrights in such Work Product shall constitute City property. If it is determined under federal law that the Work Product is not “works for hire,” Consultant hereby assigns to City all copyrights to the Work Product when and as created, and shall require sub-Consultants to do the same. Consultant may retain copyrights to its standard details, but hereby grants City a perpetual, non-exclusive license to use such details.

**7.3 Patents and Licenses.** Consultant must pay royalties or license fees required for authorized use of any third party intellectual property, including but not limited to patented, trademarked, or copyrighted intellectual property if incorporated into the Services or Work Product of this Agreement.

**7.4 Re-Use of Work Product.** Unless prohibited by law and without waiving any rights, City may use or modify the Work Product of Consultant and its sub-Consultants to execute or implement any of the following, but Consultant shall not be responsible or liable for City’s re-use of Work Product:

- (a) For work related to the original Services for which Consultant was hired;
- (b) To complete the original Services with City personnel, agents or other Consultants;
- (c) To make subsequent additions to the original Services; and/or
- (d) For other City projects.

**7.5 Deliverables and Format.** Electronic and hard copies of the Work Product constitute part of the Deliverables required under this Agreement, which shall be provided to City on recycled paper and copied on both sides, except for one single-sided original. Large-scale architectural plans and similar items must be in CAD and PDF formats, and unless otherwise specified, other documents must be in Microsoft Office applications and PDF formats.

## **8. RECORDS**

**8.1** Consultant must maintain complete, accurate, and detailed accounting records relating to the Services and Compensation, in accordance with generally accepted accounting principles and procedures. The records must include detailed information about Consultant's performance, benchmarks, and deliverables. The records and supporting documents must be kept separate from other files and maintained for a period of four (4) years from the date of City's final payment.

**8.2** Consultant will provide City full access to Consultant's books and records for review and audit, to make transcripts or copies, and to conduct a preliminary examination of all the work, data, documents, proceedings, and activities related to this Agreement. If a supplemental examination or audit of Consultant's records discloses non-compliance with appropriate internal financial controls, a contract breach, or a failure to act in good faith, City will be entitled to recover from Consultant the costs of the supplemental examination. If this is a lump sum fee Agreement, City will be provided access to records of reimbursable expenses and the instruments of service/deliverables for review and audit. This Section 8 survives the expiration/termination of this Agreement.

## **9. ASSIGNMENT**

Consultant shall not assign, sublease, hypothecate, or transfer this Agreement, or any interest therein, directly or indirectly, by operation of law or otherwise, without prior written consent of City. Any attempt to do so will be null and void. Any changes related to the financial control or business nature of Consultant as a legal entity will be considered an Assignment subject to City approval, which shall not be unreasonably withheld. For purposes of this provision, control means fifty percent (50%) or more of the voting power of the business entity. This Agreement binds Consultant, its heirs, successors and assignees.

## **10. PUBLICITY / SIGNS**

Any publicity generated by Consultant for the project under this Agreement, during the term of this Agreement and for one (1) year thereafter, will reference the City's contributions in making the project possible. The words "City of Cupertino" will be displayed in all pieces of publicity, including flyers, press releases, posters, brochures, public service announcements, interviews, and newspaper articles. No signs may be posted, exhibited, or displayed on or about City property, except signage required by law or this Agreement, without prior written approval from the City.

## **11. INDEMNIFICATION**

**11.1** To the fullest extent allowed by law and except for losses caused by the sole or active negligence or willful misconduct of City personnel, Consultant agrees to indemnify, defend, and hold harmless the City as follows:

**a. Indemnity for Design Professional Liability:** With respect to the performance of design professional services by a design professional as defined in California Civil Code Section 2782.8, to the fullest extent permitted by law, Consultant shall indemnify and hold harmless City, its officers, officials, agents, employees, and volunteers (collectively and/or individually "City") from and against any and all liabilities, claims, damages, losses, costs, or expenses (including, without limitation, costs, attorneys' fees, and expert fees of litigation and alternative dispute resolution) of every nature to the extent arising out of, pertaining to, or relating to the negligence, recklessness, or

---

willful misconduct of Consultant or any of its officers, employees, servants, agents, or subcontractors (collectively and/or individually “Consultant”), in the performance of this Agreement or failure to comply with any obligations of the Agreement. If it is finally determined (through a non-appealable judgment or an agreement between City and Consultant) that liability is caused by the comparative negligence or willful misconduct of City, then Consultant’s indemnification and hold harmless obligation shall not exceed Consultant’s finally determined percentage of liability based upon the comparative fault of Consultant.

Irrespective of any language to the contrary in this Agreement, the Consultant has no duty to provide or to immediately pay for an up-front defense of City against unproven claims or allegations, but shall reimburse those litigation costs and expenses (including, without limitation, attorneys’ fees, and expert fees) incurred by the City to the extent caused by the negligence, recklessness, or willful misconduct of Consultant. In no event shall the cost to defend charged to Consultant exceed Consultant’s proportional percentage of fault, except as described in Section 2782.8(a) and (e) of the California Civil Code.

**b. Claims Involving Intellectual Property.** Consultant shall indemnify, defend, and hold harmless Indemnitees from and against any claim involving intellectual property, infringement, or violation of a United States patent right or copyright, trade secret, trademark, or service mark or other proprietary or intellectual property rights, which arises out of, pertains to, or relates to Consultant’s negligence, recklessness, or willful misconduct. Such costs and expenses will include reasonable attorney fees for legal counsel of City’s choice, expert fees, and all other costs and fees of litigation.

**c. Claims for Other Liability.** Except as provided in subsections 11.1(a) and (b), to the fullest extent permitted by law, Consultant shall hold harmless, defend (with counsel agreed to by City), and indemnify City and its officers, officials, agents, employees, and volunteers (collectively and/or individually “City”) from and against any and all liability, claim, loss, damage, expense, costs (including, without limitation, costs, attorneys’ fees, and expert fees of litigation) of every nature arising out of, related to, or in connection with the performance of work hereunder by Consultant or any of its officers, employees, servants, agents, or subcontractors, or the failure of the same to comply with any of the obligations contained in this Agreement, except such loss or damage which was caused by the sole negligence or sole willful misconduct of the City.

Consultant’s duty to defend applies immediately, whether or not liability is established. An allegation or determination that persons other than Contractor are responsible for the claim does not relieve Contractor from its separate and distinct obligation to defend as stated herein.

**11.2** Consultant will assist City, at no additional cost, in the defense of any claim, dispute, or lawsuit arising out of this Agreement. Consultant’s duties herein are not limited to or subject to the Contract Price, to Workers’ Compensation claims, or to the Insurance or Bond limits and provisions. Nothing in this Agreement shall be construed to give rise to an implied right of indemnity in favor of Consultant against any Indemnitee.

**11.3** Consultant agrees to pay the reasonable costs City may incur in enforcing this provision related to Consultant’s indemnification duties, including reasonable attorney fees, fees for legal counsel acceptable to City, expert fees, and all other costs and expenses related to a claim or counterclaim, a purchase order, another transaction, litigation, or dispute resolution. Without waiving any rights, City



may deduct money from Consultant's payments to cover moneys due to City.

**11.4** Consultant agrees to obtain executed indemnity agreements with provisions identical to those set forth here in this Section 11 from each and every subcontractor, or any other person or entity involved by, for, with, or on behalf of Consultant in the performance of this Agreement. Failure of City to monitor compliance with these requirements imposes no additional obligations on City and will in no way act as a waiver of any rights hereunder.

**11.5** This Section 11 shall survive expiration or termination of this Agreement.

## **12. INSURANCE**

On or before the Contract Time commences, Consultant shall furnish City with proof of compliance with City Insurance Requirements, attached and incorporated here as **Exhibit D**. City will not execute the Agreement until Consultant has submitted and City has reasonably approved receipt of satisfactory certificates of insurance and endorsements evidencing the type, amount, class of operations covered, and the effective and expiration dates of coverage. Alternatively, City may terminate this Agreement or in its sole discretion purchase insurance at Consultant's expense and deduct costs from payments to Consultant.

## **13. COMPLIANCE WITH LAWS**

**13.1 General Laws.** Consultant shall comply with all laws and regulations applicable to this Agreement. Consultant will promptly notify City of changes in the law or other conditions that may affect the Project or Consultant's ability to perform. Consultant is responsible for verifying the employment authorization of employees performing the Services, as required by the Immigration Reform and Control Act, or other federal or state law, rule or regulation.

**13.2 Labor Laws.** Consultant shall comply with all labor laws applicable to this Agreement. If the Services include a "public works" component, Consultant must comply with prevailing wage laws under Labor Code Section 1720 and other labor laws. To the extent applicable, Consultant must comply with City's Labor Compliance Program and with state labor laws pertaining to working days, overtime, payroll records and DIR Registration and Oversight. If the Contract Price is \$30,000 or more, Consultant must comply with the apprenticeship requirement in Labor Code Section 1777.5.

**13.3 Discrimination Laws.** Consultant shall not discriminate on the basis of race, religious creed, color, ancestry, national origin, ethnicity, handicap, disability, marital status, pregnancy, age, sex, gender, sexual orientation, gender identity, Acquired-Immune Deficiency Syndrome (AIDS), or any other protected classification. Consultant shall comply with all anti-discrimination laws, including Government Code Section 12900 and 11135, and Labor Code Section. 1735, 1777, and 3077.5. Consistent with City policy prohibiting it, Consultant understands that harassment and discrimination by Consultant or any of its sub-Consultants toward a job applicant, an employee, a City employee, or any other person is strictly prohibited.

**13.4 Conflicts of Interest.** Consultant shall comply with all conflict of interest laws and regulations applicable to this Agreement and must avoid any conflict of interest. Consultant warrants that no public official, employee, or member of a City board or commission who might have been involved in the making of this Agreement, has or will receive a direct or indirect financial interest in this Agreement in violation of California Government Code Section 1090 et seq. Consultant may be

required to file a conflict of interest form if Consultant makes certain governmental decisions or serves in a staff capacity, as provided in Section 18700 of Title 2 of the California Code of Regulations and other laws. Services may only be performed by persons who are not employed by City and who do not have any contractual relationship with City, with the exception of this Agreement. Consultant is familiar with and agrees to abide by the City's rules governing gifts to public officials and employees.

**13.5 Remedies.** A violation of this Section 13 constitutes a material breach and may result in City suspending payments, requiring reimbursement, or terminating this Agreement. City reserves all its rights and remedies under law and this Agreement, including the right to seek indemnification under Section 11. Consultant agrees to indemnify, defend, and hold City harmless from and against any loss, liability, and expenses arising from noncompliance with this Section.

#### **14. PROJECT COORDINATION**

**14.1 City Project Manager.** The City's Project Manager for all purposes under this Agreement will be Albert Salvador, who shall have the authority to manage this Agreement and oversee the progress and performance of the Services. City in its sole discretion may substitute another Project Manager at any time and will advise Consultant of the new representative.

**14.2 Consultant Project Manager.** Subject to City's reasonable approval, Consultant's Project Manager for all purposes under this Agreement will be Michael Loomis, who shall be the single representative for Consultant with the authority to manage compliance with this Agreement and oversee the progress and performance of the Services. This includes responsibility for coordinating and scheduling the Services in accordance with City instructions, service orders, and the Schedule of Performance, and providing regular updates to the City's Project Manager on the Project status, progress, and any delays. City written approval is required prior to Consultant substituting a new Project Manager, which shall result in no additional costs to City or Project delays.

#### **15. ABANDONMENT OF PROJECT**

City may abandon or postpone the Project with thirty (30) calendar days written notice to Consultant. Consultant will be compensated for satisfactory Services performed through the date of abandonment and will be given reasonable time to assemble the work and close out the Services. No close out work shall be conducted without City reasonable approval of closure costs, which may not exceed ten percent (10%) of the total time expended to the date of abandonment. All charges including job closure costs will be paid in accordance with the provisions of this Agreement and within thirty (30) days of Consultant's final invoice reasonably approved by the City.

#### **16. TERMINATION**

City may terminate this Agreement for cause or without cause at any time, following reasonable written notice to Consultant at least thirty (30) calendar days prior to the termination date. Consultant will be paid for satisfactory Services rendered through the date of termination, but final payment will not be made until Consultant closes out the Services and delivers all Work Product to City. All charges approved by City including job closure costs will be paid within thirty (30) days of Consultant's final invoice.

#### **17. GOVERNING LAW, VENUE, AND DISPUTE RESOLUTION**

This Agreement is governed by the laws of the State of California, excepting any choice of law rules which may direct the application of laws of another jurisdiction. Any lawsuits filed related to this Agreement must be filed with the Superior Court for the County of Santa Clara, State of California. Consultant must comply with the claims filing requirements under the Government Code prior to filing a civil action in court against City. The Agreement and obligations of the parties are subject to all valid laws, orders, rules, and regulations of the authorities having jurisdiction over this Agreement (or the successors of those authorities). If a dispute arises, Consultant must continue to provide the Services pending resolution of the dispute. If the Parties elect arbitration, the arbitrator's award must be supported by law and substantial evidence and include detailed written findings of law and fact.

#### **18. ATTORNEY FEES**

If City initiates legal action, files a complaint or cross-complaint, or pursues arbitration, appeal or other proceedings to enforce its rights or a judgment in connection with this Agreement, the prevailing party will be entitled to reasonable attorney fees and costs. This Section 18 survives the expiration/termination of this Agreement.

#### **19. THIRD PARTY BENEFICIARIES**

There are no intended third party beneficiaries of this Agreement.

#### **20. WAIVER**

Neither acceptance of the Services nor payment thereof shall constitute a waiver of any contract provision. City's waiver of any breach shall not be deemed to constitute waiver of another term, provision, covenant, or condition or a subsequent breach, whether of the same or a different character

#### **21. ENTIRE AGREEMENT**

This Agreement represents the full and complete understanding of the Parties, of every kind or nature, and supersedes any and all other agreements and understandings, either oral or written, between them. Any modification of this Agreement will be effective only if in writing and signed by each Party's authorized representative. No verbal agreement or implied covenant will be valid to amend or abridge this Agreement. If there is any inconsistency between any term, clause, or provision of this main Agreement and any term, clause, or provision of the attachments or exhibits thereto, the terms of the main Agreement shall prevail and be controlling.

#### **22. INSERTED PROVISIONS**

Each contractual provision or clause that may be required by law is deemed to be included and will be inferred in this Agreement. Either party may request an amendment to cure any mistaken insertion or omission of a required provision.

#### **23. HEADINGS**

The headings in this Agreement are for convenience only, are not a part of the Agreement and in no way affect, limit, or amplify the terms or provisions of this Agreement.

#### **24. SEVERABILITY/PARTIAL INVALIDITY**



If any term or provision of this Agreement, or their application to a particular situation, is found by the court to be void, invalid, illegal or unenforceable, such term or provision shall remain in force and effect to the extent allowed by such ruling. All other terms and provisions of this Agreement or their application to specific situations shall remain in full force and effect.

**25. SURVIVAL**

All provisions which by their nature must continue after the Agreement ends, including without limitation those referenced in specific Sections herein, survive this Agreement and shall remain in full force and effect.

**26. NOTICES**

All notices, requests, and approvals must be sent to the persons below in writing to the persons below, and will be considered effective on the date of personal delivery, the delivery date confirmed by a reputable overnight delivery service, on the fifth calendar day after deposit in the United States Mail, postage prepaid, registered or certified, or the next business day following electronic submission:

<b>To City of Cupertino:</b> 10300 Torre Avenue Cupertino, CA 95014 Attention: Albert Salvador  Email: alberts@cupertino.org	<b>To Consultant:</b> CSG Consultants, Inc 3150 Almaden Expressway, #255 San Jose, CA 95118 Attention: Michael Loomis  Email: michaelloomis@csgengr.com
--	--

**27. VALIDITY OF CONTRACT**

This Agreement is valid and enforceable only if it complies with the contract provisions of Cupertino Municipal Code Chapters 3.22 and 3.23, is signed by the City Manager or authorized designee, and is approved for form by the City Attorney’s Office.

**28. EXECUTION**

The person executing this Agreement on behalf of Consultant represents and warrants that Consultant has the right, power, and authority to enter into this Agreement and carry out all actions herein, and that he or she is authorized to execute this Agreement, which constitutes a legally binding obligation of Consultant. This Agreement may be executed in counterparts, each one of which is deemed an original and all of which, taken together, constitute a single binding instrument.

**IN WITNESS WHEREOF**, the parties have caused the Agreement to be executed on the Effective Date stated earlier in this Agreement.

**CITY OF CUPERTINO**  
A Municipal Corporation

By \_\_\_\_\_  
Name \_\_\_\_\_  
Title \_\_\_\_\_  
Date \_\_\_\_\_  
Tax I.D. No.: \_\_\_\_\_

By \_\_\_\_\_  
Name \_\_\_\_\_  
Title \_\_\_\_\_  
Date \_\_\_\_\_

**APPROVED AS TO FORM:**

\_\_\_\_\_  
HEATHER M. MINNER  
Cupertino City Attorney

**ATTEST:**

\_\_\_\_\_  
KIRSTEN SQUARCIA  
City Clerk  
DATE: \_\_\_\_\_

\_\_\_\_\_

PROPOSAL TO THE

# City of Cupertino

FOR

## Building Plan Check Services Town Center Project (former Vallco Mall Site)

PREPARED BY

**CSG Consultants, Inc.**

January 21, 2020

3150 Almaden Expressway #255, San Jose, 95118  
phone 408.618.8300 | fax 408.618.8310 | [www.csgegr.com](http://www.csgegr.com)  
Foster City • Pleasanton • San Jose • Sacramento • Newman • Orange • Redlands



*Employee-Owned*

# Cover Letter

January 21, 2020

Albert Salvador, PE, CBO  
Building Official  
10300 Torre Avenue  
Cupertino, CA 95014

## Re: Professional Building Plan Check Services for the Town Center Project (former Vallco Mall Site)

Dear Mr. Salvador:

**CSG Consultants, Inc.** (CSG) is pleased to present this cost proposal for professional building plan check and inspection services to the City of Cupertino (City) for its Town Center project. We are excited at the prospect of working with the City on this important project, to which our firm will bring:

- an existing, successful working relationship with the City;
- specialized expertise, including CASp plan review;
- an experienced project manager committed to delivering thorough, accurate and timely services on this high profile, fast-tracked project;
- a deep pool of experienced, licensed/certified, collaborative, customer service-focused building department staff;
- proven digital plan submission, distribution, plan review, and web-based status reporting; and
- expeditious plan review turnaround times (while ensuring code compliant projects).

CSG can readily provide the requested services with the personnel included in our qualifications proposal, previously submitted. All proposed CSG plan review personnel are registered and/or ICC certified, with additional qualifications including LEED, DSA, and CASp experience and certification. Many of our proposed team members are cross-trained in multiple service levels, providing the City with increased efficiency to meet their fluctuating needs.

CSG currently furnishes building and safety, fire prevention, code enforcement, public works, planning, and other municipal services to over 175 clients throughout California. For over 28 years, we have had a solutions-oriented approach to our work, leveraging our team's depth and breadth of experience and technical expertise to address code compliance challenges for our clients.

Our corporate office is in Foster City and our local office is in San Jose; our team will be available for meetings at the City's offices when required. Michael Loomis, SE, CBO, CASp, LEED AP will serve as the primary contact for this contract. His contact information is as follows:

**Michael Loomis, SE, CBO, CASp, LEED AP**

3150 Almaden Expressway #255, San Jose, CA 95118

office (408) 618-8300 | cell (650) 696-0654 | michaelloomis@csgengr.com

Please feel free to contact Mr. Loomis with any questions or comments you may have regarding our proposal. We look forward to the opportunity to provide building plan check services to the City for this important project.

Sincerely,

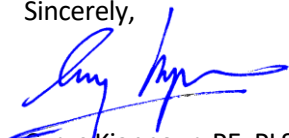

Cyrus Kianpour, PE, PLS  
President, CSG Consultants, Inc.



## Project Understanding & Scope of Services

### PROJECT DESCRIPTION

The “Town Center” project site is located on the 50.82-acre Vallco Mall property in the City of Cupertino, between Interstate 280 and Steven’s Creek Boulevard and on both sides of North Wolfe Road. The project includes a mixed-use Town Center redevelopment of the Vallco Mall property with residential, commercial office and commercial retail.

From review of the plans provided to CSG in December of 2018, CSG understands that development of the Town Center will include multiple buildings (depicted in schematic below), underground and surface parking, a green roof, and multiple tenant improvements which will come later during the course of the project.

#### Site Schematic

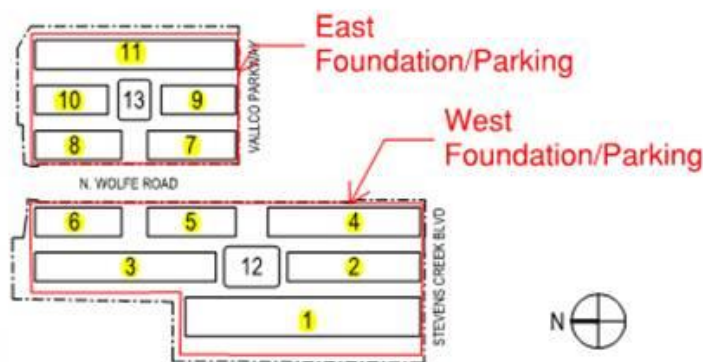

### SCOPE OF SERVICES

CSG is submitting its proposal for building plan review services for **core & shell permits for the foundation and superstructures for 11 buildings, parking structure with foundation, and green roof structure**. CSG’s fee for this work excludes site work and tenant improvements.

#### Plan Check Turnaround Times

Our goal will be to approve a code-complying project and to successfully and quickly move work through the City’s processes and to coordinate effectively with other City departments or outside agencies. CSG will ensure that all building and safety duties and follow-up actions will be performed in a timely and responsive manner. If a review is anticipated to take longer than the maximum turnaround timing, CSG will notify the City with advanced notice and negotiate additional time required to ensure an appropriate level of review.

CSG proposes the following plan review turnaround times for this project.

TYPE OF REVIEW	INITIAL REVIEW (BUSINESS DAYS)	RE-CHECK (BUSINESS DAYS)
Standard Building Plan Review	20	15
Expedited Building Plan Review	15	10
Revisions / Addendums	10	10
RFIs & Deferred Submittals	5	5

## Fee Schedule

### RATES AND NOT-TO-EXCEED FEE

CSG's cost schedule for proposed work is provided in the table below. CSG will coordinate the pickup and return of all plans to CSG via staff or a licensed courier service. This service is provided at no additional cost.

#### Offsite Plan Review Services

Building plan review fees indicated below that are based on a percentage of the City's plan check fee include the initial plan review and one subsequent review. Additional building plan reviews, revisions, addendums, RFIs, deferred submittals and similar reviews will be charged at the appropriate hourly building plan review rate indicated below on each review cycle.

ROLE / SERVICE	PERCENTAGE-BASED FEE / HOURLY RATE
Standard Building Plan Review	65% of City's Building Plan Check Fees
Expedited Building Plan Review	95% of City's Building Plan Check Fees
Hourly Building Plan Review	\$130
Expedited Building Plan Review (Hourly)	1.5 x Hourly Rate

#### Onsite Plan Review Services

At the City's request, CSG can provide *onsite* plan review services at the City's offices at the rate provided below. The cost for full-time plan review services for a duration of 3 years is provided as the not-to-exceed amount for this service below.

ROLE / SERVICE	HOURLY RATE	NOT-TO-EXCEED COST
Onsite Building Plan Review	\$185	\$1.15M

*Fees are based on the building plan sets dated December 2018 and provided to CSG by the City in January 2019.*

*All hourly rates include overhead costs including, but not limited to, salaries, benefits, Workers Compensation Insurance, and office expenses. Should the scope of work change or circumstances develop which necessitate special handling, we will notify the City prior to proceeding. Annual adjustments may be made by mutual agreement based upon current CPI. CSG will mail an invoice every month for services rendered during the previous month.*



**EXHIBIT D**  
***Insurance Requirements***  
***Design Professionals & Consultants Contracts***

Consultant shall procure prior to commencement of Services and maintain for the duration of the contract, at its own cost and expense, the following insurance policies and coverage with companies doing business in California and acceptable to City.

**INSURANCE POLICIES AND MINIMUMS REQUIRED**

1. ***Commercial General Liability*** (CGL) for bodily injury, property damage, personal injury liability for premises operations, products and completed operations, contractual liability, and personal and advertising injury with limits no less than **\$2,000,000** per occurrence (ISO Form CG 00 01). If a general aggregate limit applies, either the general aggregate limit shall apply separately to this project/location (ISO Form CG 25 03 or 25 04) or it shall be twice the required occurrence limit.
  - a. It shall be a requirement that any available insurance proceeds broader than or in excess of the specified minimum insurance coverage requirements and/or limits shall be made available to the Additional Insured and shall be (i) the minimum coverage/limits specified in this agreement; or (ii) the broader coverage and maximum limits of coverage of any insurance policy, whichever is greater.
  - b. Additional Insured coverage under Consultant's policy shall be "primary and non-contributory," will not seek contribution from City's insurance/self-insurance, and shall be at least as broad as ISO Form CG 20 01 (04/13).
  - c. The limits of insurance required may be satisfied by a combination of primary and umbrella or excess insurance, provided each policy complies with the requirements set forth in this Contract. Any umbrella or excess insurance shall contain or be endorsed to contain a provision that such coverage shall also apply on a primary basis for the benefit of City before the City's own insurance or self-insurance shall be called upon to protect City as a named insured.
2. ***Automobile Liability***: ISO CA 00 01 covering any auto (including owned, hired, and non-owned autos) with limits no less than **\$1,000,000** per accident for bodily injury and property damage.
3. ***Workers' Compensation***: As required by the State of California, with Statutory Limits and Employer's Liability Insurance of no less than **\$1,000,000** per occurrence for bodily injury or disease.  
/ *Not required. Consultant has provided written verification of no employees.*
4. ***Professional Liability*** for professional acts, errors and omissions, as appropriate to Consultant's profession, with limits no less than **\$2,000,000** per occurrence or **\$2,000,000** aggregate. If written on a claims made form:
  - a. The Retroactive Date must be shown and must be before the Effective Date of the Contract.
  - b. Insurance must be maintained for at least five (5) years after completion of the Services.
  - c. If coverage is canceled or non-renewed, and not replaced with another claims-made policy form with a Retroactive Date prior to the Contract Effective Date, the Consultant must purchase "extended reporting" coverage for a minimum of five (5) years after completion of the Services.

**OTHER INSURANCE PROVISIONS**

The aforementioned insurance shall be endorsed and have all the following conditions and provisions:

***Additional Insured Status***

The City of Cupertino, its City Council, officers, officials, employees, agents, servants and volunteers ("Additional Insureds") are to be covered as additional insureds on Consultant's CGL and automobile liability policies. General Liability coverage can be provided in the form of an endorsement to Consultant's insurance (at least as broad as ISO Form CG 20 10 (11/ 85) or both CG 20 10 and CG 20 37 forms, if later editions are used).

***Primary Coverage***

Coverage afforded to City/Additional Insureds shall be primary insurance. Any insurance or self-insurance maintained by City, its officers, officials, employees, or volunteers shall be excess of Consultant's insurance and shall not contribute to it.

***Notice of Cancellation***

Each insurance policy shall state that coverage shall not be canceled or allowed to expire, except with written notice to City 30 days in advance or 10 days in advance if due to non-payment of premiums.

***Waiver of Subrogation***

Consultant waives any right to subrogation against City/Additional Insureds for recovery of damages to the extent said losses are covered by the insurance policies required herein. Specifically, the Workers' Compensation policy shall be endorsed with a waiver of subrogation in favor of City for all work performed by Consultant, its employees, agents and subconsultants. This provision applies regardless of whether or not the City has received a waiver of subrogation endorsement from the insurer.

***Deductibles and Self-Insured Retentions***

Any deductible or self-insured retention must be declared to and approved by the City. At City's option, either: the insurer must reduce or eliminate the deductible or self-insured retentions as respects the City/Additional Insureds; or Consultant must show proof of ability to pay losses and costs related investigations, claim administration and defense expenses. The policy shall provide, or be endorsed to provide, that the self-insured retention may be satisfied by either the insured or the City.

***Acceptability of Insurers***

Insurers must be licensed to do business in California with an A.M. Best Rating of A-VII, or better.

***Verification of Coverage***

Consultant must furnish acceptable insurance certificates and mandatory endorsements (or copies of the policies effecting the coverage required by this Contract), and a copy of the Declarations and Endorsement Page of the CGL policy listing all policy endorsements prior to commencement of the Contract. City retains the right to demand verification of compliance at any time during the Contract term.

***Subconsultants***

Consultant shall require and verify that all subconsultants maintain insurance that meet the requirements of this Contract, including naming the City as an additional insured on subconsultant's insurance policies.

***Higher Insurance Limits***

If Consultant maintains broader coverage and/or higher limits than the minimums shown above, City shall be entitled to coverage for the higher insurance limits maintained by Consultant.

***Adequacy of Coverage***

City reserves the right to modify these insurance requirements/coverage based on the nature of the risk, prior experience, insurer or other special circumstances, with not less than ninety (90) days prior written notice.



# CERTIFICATE OF LIABILITY INSURANCE

DATE (MM/DD/YYYY)

1/27/2020

THIS CERTIFICATE IS ISSUED AS A MATTER OF INFORMATION ONLY AND CONFERS NO RIGHTS UPON THE CERTIFICATE HOLDER. THIS CERTIFICATE DOES NOT AFFIRMATIVELY OR NEGATIVELY AMEND, EXTEND OR ALTER THE COVERAGE AFFORDED BY THE POLICIES BELOW. THIS CERTIFICATE OF INSURANCE DOES NOT CONSTITUTE A CONTRACT BETWEEN THE ISSUING INSURER(S), AUTHORIZED REPRESENTATIVE OR PRODUCER, AND THE CERTIFICATE HOLDER.

**IMPORTANT:** If the certificate holder is an **ADDITIONAL INSURED**, the policy(ies) must have **ADDITIONAL INSURED** provisions or be endorsed. If **SUBROGATION IS WAIVED**, subject to the terms and conditions of the policy, certain policies may require an endorsement. A statement on this certificate does not confer rights to the certificate holder in lieu of such endorsement(s).

<b>PRODUCER</b> Arthur J. Gallagher & Co. Insurance Brokers of CA, Inc. LIC #0726293 1255 Battery Street, Suite 450 San Francisco CA 94111	<b>CONTACT NAME:</b> <b>PHONE (A/C, No, Ext):</b> 415-536-8617 <b>E-MAIL ADDRESS:</b> certrequests@ajg.com <b>FAX (A/C, No):</b> 415-536-8627
<b>INSURED</b> CSG Consultants, Inc. 550 Pilgrim Drive Foster City, CA 94404	<b>INSURER(S) AFFORDING COVERAGE</b> <b>INSURER A:</b> American Fire and Casualty Company <b>INSURER B:</b> Arch Insurance Company <b>INSURER C:</b> West American Insurance Company <b>INSURER D:</b> Redwood Fire and Casualty Insurance Co <b>INSURER E:</b> <b>INSURER F:</b>

**COVERAGES****CERTIFICATE NUMBER:** 16506485**REVISION NUMBER:**

THIS IS TO CERTIFY THAT THE POLICIES OF INSURANCE LISTED BELOW HAVE BEEN ISSUED TO THE INSURED NAMED ABOVE FOR THE POLICY PERIOD INDICATED. NOTWITHSTANDING ANY REQUIREMENT, TERM OR CONDITION OF ANY CONTRACT OR OTHER DOCUMENT WITH RESPECT TO WHICH THIS CERTIFICATE MAY BE ISSUED OR MAY PERTAIN, THE INSURANCE AFFORDED BY THE POLICIES DESCRIBED HEREIN IS SUBJECT TO ALL THE TERMS, EXCLUSIONS AND CONDITIONS OF SUCH POLICIES. LIMITS SHOWN MAY HAVE BEEN REDUCED BY PAID CLAIMS.

INSR LTR	TYPE OF INSURANCE	ADDL INSD	SUBR WVD	POLICY NUMBER	POLICY EFF (MM/DD/YYYY)	POLICY EXP (MM/DD/YYYY)	LIMITS
C	<input checked="" type="checkbox"/> <b>COMMERCIAL GENERAL LIABILITY</b> <input type="checkbox"/> CLAIMS-MADE <input checked="" type="checkbox"/> OCCUR GEN'L AGGREGATE LIMIT APPLIES PER: <input type="checkbox"/> POLICY <input type="checkbox"/> PRO-JECT <input checked="" type="checkbox"/> LOC OTHER:	Y	Y	BKW60684163	12/4/2019	2/2/2020	EACH OCCURRENCE \$1,000,000 DAMAGE TO RENTED PREMISES (Ea occurrence) \$500,000 MED EXP (Any one person) \$5,000 PERSONAL & ADV INJURY \$1,000,000 GENERAL AGGREGATE \$2,000,000 PRODUCTS - COMP/OP AGG \$2,000,000 No Ded \$
A	<input checked="" type="checkbox"/> <b>AUTOMOBILE LIABILITY</b> <input checked="" type="checkbox"/> ANY AUTO <input type="checkbox"/> OWNED AUTOS ONLY <input type="checkbox"/> SCHEDULED AUTOS <input type="checkbox"/> HIRED AUTOS ONLY <input type="checkbox"/> NON-OWNED AUTOS ONLY	Y	Y	BAA60684163	12/4/2019	2/2/2020	COMBINED SINGLE LIMIT (Ea accident) \$1,000,000 BODILY INJURY (Per person) \$ BODILY INJURY (Per accident) \$ PROPERTY DAMAGE (Per accident) \$ No Ded \$
A	<input checked="" type="checkbox"/> <b>UMBRELLA LIAB</b> <input checked="" type="checkbox"/> OCCUR <input type="checkbox"/> EXCESS LIAB <input type="checkbox"/> CLAIMS-MADE DED <input checked="" type="checkbox"/> RETENTION \$ 0	Y	Y	USA60684163	12/4/2019	2/2/2020	EACH OCCURRENCE \$5,000,000 AGGREGATE \$5,000,000 \$
D	<b>WORKERS COMPENSATION AND EMPLOYERS' LIABILITY</b> ANY PROPRIETOR/PARTNER/EXECUTIVE OFFICER/MEMBER EXCLUDED? (Mandatory in NH) If yes, describe under DESCRIPTION OF OPERATIONS below	Y/N N	N/A	CSWC036787	12/4/2019	12/4/2020	<input checked="" type="checkbox"/> PER STATUTE <input type="checkbox"/> OTH-ER No Ded E.L. EACH ACCIDENT \$1,000,000 E.L. DISEASE - EA EMPLOYEE \$1,000,000 E.L. DISEASE - POLICY LIMIT \$1,000,000
B	Professional Liability retro date: 1/1/1991		Y	PAAEP0008804	12/4/2019	12/4/2020	Each Claim \$5,000,000 Aggregate \$5,000,000 Deductible: \$50,000

**DESCRIPTION OF OPERATIONS / LOCATIONS / VEHICLES (ACORD 101, Additional Remarks Schedule, may be attached if more space is required)**  
RE: Vallco Town Center

**CERTIFICATE HOLDER****CANCELLATION**

City of Cupertino  
10300 Torre Avenue  
Cupertino CA 95014

SHOULD ANY OF THE ABOVE DESCRIBED POLICIES BE CANCELLED BEFORE THE EXPIRATION DATE THEREOF, NOTICE WILL BE DELIVERED IN ACCORDANCE WITH THE POLICY PROVISIONS.

AUTHORIZED REPRESENTATIVE

© 1988-2015 ACORD CORPORATION. All rights reserved.

**THIS ENDORSEMENT CHANGES THE POLICY. PLEASE READ IT CAREFULLY.**

## **COMMERCIAL GENERAL LIABILITY EXTENSION**

This endorsement modifies insurance provided under the following:

### **COMMERCIAL GENERAL LIABILITY COVERAGE PART**

#### **INDEX**

<b><u>SUBJECT</u></b>	<b><u>PAGE</u></b>
<b>NON-OWNED AIRCRAFT</b>	<b>2</b>
<b>NON-OWNED WATERCRAFT</b>	<b>2</b>
<b>PROPERTY DAMAGE LIABILITY - ELEVATORS</b>	<b>2</b>
<b>EXTENDED DAMAGE TO PROPERTY RENTED TO YOU (Tenant's Property Damage)</b>	<b>2</b>
<b>MEDICAL PAYMENTS EXTENSION</b>	<b>3</b>
<b>EXTENSION OF SUPPLEMENTARY PAYMENTS - COVERAGES A AND B</b>	<b>3</b>
<b>ADDITIONAL INSURED - BY CONTRACT, AGREEMENT OR PERMIT</b>	<b>3</b>
<b>PRIMARY AND NON-CONTRIBUTORY- ADDITIONAL INSURED EXTENSION</b>	<b>5</b>
<b>ADDITIONAL INSURED - EXTENDED PROTECTION OF YOUR "LIMITS OF INSURANCE"</b>	<b>6</b>
<b>WHO IS AN INSURED - INCIDENTAL MEDICAL ERRORS/MALPRACTICE AND WHO IS AN INSURED - FELLOW EMPLOYEE EXTENSION - MANAGEMENT EMPLOYEES</b>	<b>6</b>
<b>NEWLY FORMED OR ADDITIONALLY ACQUIRED ENTITIES</b>	<b>7</b>
<b>FAILURE TO DISCLOSE HAZARDS AND PRIOR OCCURRENCES</b>	<b>7</b>
<b>KNOWLEDGE OF OCCURRENCE, OFFENSE, CLAIM OR SUIT</b>	<b>7</b>
<b>LIBERALIZATION CLAUSE</b>	<b>7</b>
<b>BODILY INJURY REDEFINED</b>	<b>7</b>
<b>EXTENDED PROPERTY DAMAGE</b>	<b>8</b>
<b>WAIVER OF TRANSFER OF RIGHTS OF RECOVERY AGAINST OTHERS TO US - WHEN REQUIRED IN A CONTRACT OR AGREEMENT WITH YOU</b>	<b>8</b>

With respect to coverage afforded by this endorsement, the provisions of the policy apply unless modified by the endorsement.

#### **A. NON-OWNED AIRCRAFT**

Under Paragraph 2. **Exclusions of Section I - Coverage A - Bodily Injury And Property Damage Liability**, exclusion **g. Aircraft, Auto Or Watercraft** does not apply to an aircraft provided:

1. It is not owned by any insured;
2. It is hired, chartered or loaned with a trained paid crew;
3. The pilot in command holds a currently effective certificate, issued by the duly constituted authority of the United States of America or Canada, designating her or him a commercial or airline pilot; and
4. It is not being used to carry persons or property for a charge.

However, the insurance afforded by this provision does not apply if there is available to the insured other valid and collectible insurance, whether primary, excess (other than insurance written to apply specifically in excess of this policy), contingent or on any other basis, that would also apply to the loss covered under this provision.

#### **B. NON-OWNED WATERCRAFT**

Under Paragraph 2. **Exclusions of Section I - Coverage A - Bodily Injury And Property Damage Liability**, Subparagraph (2) of exclusion **g. Aircraft, Auto Or Watercraft** is replaced by the following:

This exclusion does not apply to:

- (2) A watercraft you do not own that is:
  - (a) Less than 52 feet long; and
  - (b) Not being used to carry persons or property for a charge.

#### **C. PROPERTY DAMAGE LIABILITY - ELEVATORS**

1. Under Paragraph 2. **Exclusions of Section I - Coverage A - Bodily Injury And Property Damage Liability**, Subparagraphs (3), (4) and (6) of exclusion **j. Damage To Property** do not apply if such "property damage" results from the use of elevators. For the purpose of this provision, elevators do not include vehicle lifts. Vehicle lifts are lifts or hoists used in automobile service or repair operations.
2. The following is added to **Section IV - Commercial General Liability Conditions**, Condition 4. **Other Insurance**, Paragraph **b. Excess Insurance**:

The insurance afforded by this provision of this endorsement is excess over any property insurance, whether primary, excess, contingent or on any other basis.

#### **D. EXTENDED DAMAGE TO PROPERTY RENTED TO YOU (Tenant's Property Damage)**

If Damage To Premises Rented To You is not otherwise excluded from this Coverage Part:

1. Under Paragraph 2. **Exclusions of Section I - Coverage A - Bodily Injury and Property Damage Liability**:
  - a. The fourth from the last paragraph of exclusion **j. Damage To Property** is replaced by the following:

Paragraphs (1), (3) and (4) of this exclusion do not apply to "property damage" (other than damage by fire, lightning, explosion, smoke, or leakage from an automatic fire protection system) to:

- (i) Premises rented to you for a period of 7 or fewer consecutive days; or
- (ii) Contents that you rent or lease as part of a premises rental or lease agreement for a period of more than 7 days.

Paragraphs (1), (3) and (4) of this exclusion do not apply to "property damage" to contents of premises rented to you for a period of 7 or fewer consecutive days.

A separate limit of insurance applies to this coverage as described in **Section III - Limits of Insurance**.



- b. The last paragraph of subsection **2. Exclusions** is replaced by the following:

Exclusions c. through n. do not apply to damage by fire, lightning, explosion, smoke or leakage from automatic fire protection systems to premises while rented to you or temporarily occupied by you with permission of the owner. A separate limit of insurance applies to Damage To Premises Rented To You as described in **Section III - Limits Of Insurance**.

2. Paragraph 6. under **Section III - Limits Of Insurance** is replaced by the following:

6. Subject to Paragraph 5. above, the Damage To Premises Rented To You Limit is the most we will pay under Coverage A for damages because of "property damage" to:

- a. Any one premise:

(1) While rented to you; or

(2) While rented to you or temporarily occupied by you with permission of the owner for damage by fire, lightning, explosion, smoke or leakage from automatic protection systems; or

- b. Contents that you rent or lease as part of a premises rental or lease agreement.

3. As regards coverage provided by this provision **D. EXTENDED DAMAGE TO PROPERTY RENTED TO YOU (Tenant's Property Damage)** - Paragraph 9.a. of **Definitions** is replaced with the following:

- 9.a. A contract for a lease of premises. However, that portion of the contract for a lease of premises that indemnifies any person or organization for damage by fire, lightning, explosion, smoke, or leakage from automatic fire protection systems to premises while rented to you or temporarily occupied by you with the permission of the owner, or for damage to contents of such premises that are included in your premises rental or lease agreement, is not an "insured contract".

#### **E. MEDICAL PAYMENTS EXTENSION**

If **Coverage C Medical Payments** is not otherwise excluded, the Medical Payments provided by this policy are amended as follows:

Under Paragraph 1. **Insuring Agreement** of **Section I - Coverage C - Medical Payments**, Subparagraph (b) of Paragraph a. is replaced by the following:

- (b) The expenses are incurred and reported within three years of the date of the accident; and

#### **F. EXTENSION OF SUPPLEMENTARY PAYMENTS - COVERAGES A AND B**

1. Under **Supplementary Payments - Coverages A and B**, Paragraph 1.b. is replaced by the following:

- b. Up to **\$3,000** for cost of bail bonds required because of accidents or traffic law violations arising out of the use of any vehicle to which the Bodily Injury Liability Coverage applies. We do not have to furnish these bonds.

2. Paragraph 1.d. is replaced by the following:

- d. All reasonable expenses incurred by the insured at our request to assist us in the investigation or defense of the claim or "suit", including actual loss of earnings up to **\$500** a day because of time off from work.

#### **G. ADDITIONAL INSURED - BY CONTRACT, AGREEMENT OR PERMIT**

1. Paragraph 2. under **Section II - Who Is An Insured** is amended to include as an insured any person or organization whom you have agreed to add as an additional insured in a written contract, written agreement or permit. Such person or organization is an additional insured but only with respect to liability for "bodily injury", "property damage" or "personal and advertising injury" caused in whole or in part by:

- a. Your acts or omissions, or the acts or omissions of those acting on your behalf, in the performance of your on going operations for the additional insured that are the subject of the written contract or written agreement provided that the "bodily injury" or "property damage" occurs, or the "personal and advertising injury" is committed, subsequent to the signing of such written contract or written agreement; or



- b. Premises or facilities rented by you or used by you; or
- c. The maintenance, operation or use by you of equipment rented or leased to you by such person or organization; or
- d. Operations performed by you or on your behalf for which the state or political subdivision has issued a permit subject to the following additional provisions:
  - (1) This insurance does not apply to "bodily injury", "property damage", or "personal and advertising injury" arising out of the operations performed for the state or political subdivision;
  - (2) This insurance does not apply to "bodily injury" or "property damage" included within the "completed operations hazard".
  - (3) Insurance applies to premises you own, rent, or control but only with respect to the following hazards:
    - (a) The existence, maintenance, repair, construction, erection, or removal of advertising signs, awnings, canopies, cellar entrances, coal holes, driveways, manholes, marquees, hoist away openings, sidewalk vaults, street banners, or decorations and similar exposures; or
    - (b) The construction, erection, or removal of elevators; or
    - (c) The ownership, maintenance, or use of any elevators covered by this insurance.

However:

- 1. The insurance afforded to such additional insured only applies to the extent permitted by law; and
- 2. If coverage provided to the additional insured is required by a contract or agreement, the insurance afforded to such additional insured will not be broader than that which you are required by the contract or agreement to provide for such additional insured.

With respect to Paragraph 1.a. above, a person's or organization's status as an additional insured under this endorsement ends when:

- (1) All work, including materials, parts or equipment furnished in connection with such work, on the project (other than service, maintenance or repairs) to be performed by or on behalf of the additional insured(s) at the location of the covered operations has been completed; or
- (2) That portion of "your work" out of which the injury or damage arises has been put to its intended use by any person or organization other than another contractor or subcontractor engaged in performing operations for a principal as a part of the same project.

With respect to Paragraph 1.b. above, a person's or organization's status as an additional insured under this endorsement ends when their written contract or written agreement with you for such premises or facilities ends.

With respects to Paragraph 1.c. above, this insurance does not apply to any "occurrence" which takes place after the equipment rental or lease agreement has expired or you have returned such equipment to the lessor.

The insurance provided by this endorsement applies only if the written contract or written agreement is signed prior to the "bodily injury" or "property damage".

We have no duty to defend an additional insured under this endorsement until we receive written notice of a "suit" by the additional insured as required in Paragraph b. of Condition 2. **Duties In the Event Of Occurrence, Offense, Claim Or Suit under Section IV - Commercial General Liability Conditions.**

2. With respect to the insurance provided by this endorsement, the following are added to Paragraph 2. **Exclusions under Section I - Coverage A - Bodily Injury And Property Damage Liability:**

This insurance does not apply to:

- a. "Bodily injury" or "property damage" arising from the sole negligence of the additional insured.
- b. "Bodily injury" or "property damage" that occurs prior to you commencing operations at the location where such "bodily injury" or "property damage" occurs.
- c. "Bodily injury", "property damage" or "personal and advertising injury" arising out of the rendering of, or the failure to render, any professional architectural, engineering or surveying services, including:
  - (1) The preparing, approving, or failing to prepare or approve, maps, shop drawings, opinions, reports, surveys, field orders, change orders or drawings and specifications; or
  - (2) Supervisory, inspection, architectural or engineering activities.

This exclusion applies even if the claims against any insured allege negligence or other wrongdoing in the supervision, hiring, employment, training or monitoring of others by that insured, if the "occurrence" which caused the "bodily injury" or "property damage", or the offense which caused the "personal and advertising injury", involved the rendering of, or the failure to render, any professional architectural, engineering or surveying services.

- d. "Bodily injury" or "property damage" occurring after:
  - (1) All work, including materials, parts or equipment furnished in connection with such work, on the project (other than service, maintenance or repairs) to be performed by or on behalf of the additional insured(s) at the location of the covered operations has been completed; or
  - (2) That portion of "your work" out of which the injury or damage arises has been put to its intended use by any person or organization other than another contractor or subcontractor engaged in performing operations for a principal as a part of the same project.
- e. Any person or organization specifically designated as an additional insured for ongoing operations by a separate **ADDITIONAL INSURED -OWNERS, LESSEES OR CONTRACTORS** endorsement issued by us and made a part of this policy.

3. With respect to the insurance afforded to these additional insureds, the following is added to **Section III - Limits Of Insurance:**

If coverage provided to the additional insured is required by a contract or agreement, the most we will pay on behalf of the additional insured is the amount of insurance:

- a. Required by the contract or agreement; or
  - b. Available under the applicable Limits of Insurance shown in the Declarations;
- whichever is less.

This endorsement shall not increase the applicable Limits of Insurance shown in the Declarations.

#### **H. PRIMARY AND NON-CONTRIBUTORY ADDITIONAL INSURED EXTENSION**

This provision applies to any person or organization who qualifies as an additional insured under any form or endorsement under this policy.

**Condition 4. Other Insurance of SECTION IV - COMMERCIAL GENERAL LIABILITY CONDITIONS** is amended as follows:

- a. The following is added to Paragraph a. **Primary Insurance:**

If an additional insured's policy has an Other Insurance provision making its policy excess, and you have agreed in a written contract or written agreement to provide the additional insured coverage on a primary and noncontributory basis, this policy shall be primary and we will not seek contribution from the additional insured's policy for damages we cover.

**b. The following is added to Paragraph b. Excess Insurance:**

When a written contract or written agreement, other than a premises lease, facilities rental contract or agreement, an equipment rental or lease contract or agreement, or permit issued by a state or political subdivision between you and an additional insured does not require this insurance to be primary or primary and non-contributory, this insurance is excess over any other insurance for which the additional insured is designated as a Named Insured.

Regardless of the written agreement between you and an additional insured, this insurance is excess over any other insurance whether primary, excess, contingent or on any other basis for which the additional insured has been added as an additional insured on other policies.

**I. ADDITIONAL INSURED - EXTENDED PROTECTION OF YOUR "LIMITS OF INSURANCE"**

This provision applies to any person or organization who qualifies as an additional insured under any form or endorsement under this policy.

**1. The following is added to Condition 2. Duties In The Event Of Occurrence, Offense, Claim or Suit:**

An additional insured under this endorsement will as soon as practicable:

- a. Give written notice of an "occurrence" or an offense that may result in a claim or "suit" under this insurance to us;
- b. Tender the defense and indemnity of any claim or "suit" to all insurers whom also have insurance available to the additional insured; and
- c. Agree to make available any other insurance which the additional insured has for a loss we cover under this Coverage Part.
- d. We have no duty to defend or indemnify an additional insured under this endorsement until we receive written notice of a "suit" by the additional insured.

2. The limits of insurance applicable to the additional insured are those specified in a written contract or written agreement or the limits of insurance as stated in the Declarations of this policy and defined in **Section III - Limits of Insurance** of this policy, whichever are less. These limits are inclusive of and not in addition to the limits of insurance available under this policy.

**J. WHO IS AN INSURED - INCIDENTAL MEDICAL ERRORS / MALPRACTICE  
WHO IS AN INSURED - FELLOW EMPLOYEE EXTENSION - MANAGEMENT EMPLOYEES**

Paragraph 2.a.(1) of **Section II - Who Is An Insured** is replaced with the following:

**(1) "Bodily injury" or "personal and advertising injury":**

- (a) To you, to your partners or members (if you are a partnership or joint venture), to your members (if you are a limited liability company), to a co-"employee" while in the course of his or her employment or performing duties related to the conduct of your business, or to your other "volunteer workers" while performing duties related to the conduct of your business;
- (b) To the spouse, child, parent, brother or sister of that co-"employee" or "volunteer worker" as a consequence of Paragraph (1) (a) above;
- (c) For which there is any obligation to share damages with or repay someone else who must pay damages because of the injury described in Paragraphs (1) (a) or (b) above; or
- (d) Arising out of his or her providing or failing to provide professional health care services. However, if you are not in the business of providing professional health care services or providing professional health care personnel to others, or if coverage for providing professional health care services is not otherwise excluded by separate endorsement, this provision (Paragraph (d)) does not apply.

Paragraphs (a) and (b) above do not apply to "bodily injury" or "personal and advertising injury" caused by an "employee" who is acting in a supervisory capacity for you. Supervisory capacity as used herein means the "employee's" job responsibilities assigned by you, includes the direct supervision of other "employees" of yours. However, none of these "employees" are insureds for "bodily injury" or "personal and



advertising injury" arising out of their willful conduct, which is defined as the purposeful or willful intent to cause "bodily injury" or "personal and advertising injury", or caused in whole or in part by their intoxication by liquor or controlled substances.

The coverage provided by provision J. is excess over any other valid and collectable insurance available to your "employee".

#### **K. NEWLY FORMED OR ADDITIONALLY ACQUIRED ENTITIES**

Paragraph 3. of Section II - Who Is An Insured is replaced by the following:

3. Any organization you newly acquire or form and over which you maintain ownership or majority interest, will qualify as a Named Insured if there is no other similar insurance available to that organization. However:
  - a. Coverage under this provision is afforded only until the expiration of the policy period in which the entity was acquired or formed by you;
  - b. Coverage A does not apply to "bodily injury" or "property damage" that occurred before you acquired or formed the organization; and
  - c. Coverage B does not apply to "personal and advertising injury" arising out of an offense committed before you acquired or formed the organization.
  - d. Records and descriptions of operations must be maintained by the first Named Insured.

No person or organization is an insured with respect to the conduct of any current or past partnership, joint venture or limited liability company that is not shown as a Named Insured in the Declarations or qualifies as an insured under this provision.

#### **L. FAILURE TO DISCLOSE HAZARDS AND PRIOR OCCURRENCES**

Under Section IV - Commercial General Liability Conditions, the following is added to Condition 6. Representations:

Your failure to disclose all hazards or prior "occurrences" existing as of the inception date of the policy shall not prejudice the coverage afforded by this policy provided such failure to disclose all hazards or prior "occurrences" is not intentional.

#### **M. KNOWLEDGE OF OCCURRENCE, OFFENSE, CLAIM OR SUIT**

Under Section IV - Commercial General Liability Conditions, the following is added to Condition 2. Duties In The Event of Occurrence, Offense, Claim Or Suit:

Knowledge of an "occurrence", offense, claim or "suit" by an agent, servant or "employee" of any insured shall not in itself constitute knowledge of the insured unless an insured listed under Paragraph 1. of Section II - Who Is An Insured or a person who has been designated by them to receive reports of "occurrences", offenses, claims or "suits" shall have received such notice from the agent, servant or "employee".

#### **N. LIBERALIZATION CLAUSE**

If we revise this Commercial General Liability Extension Endorsement to provide more coverage without additional premium charge, your policy will automatically provide the coverage as of the day the revision is effective in your state.

#### **O. BODILY INJURY REDEFINED**

Under Section V - Definitions, Definition 3. is replaced by the following:

3. "Bodily Injury" means physical injury, sickness or disease sustained by a person. This includes mental anguish, mental injury, shock, fright or death that results from such physical injury, sickness or disease.

**P. EXTENDED PROPERTY DAMAGE**

Exclusion a. of **COVERAGE A. BODILY INJURY AND PROPERTY DAMAGE LIABILITY** is replaced by the following:

**a. Expected Or Intended Injury**

"Bodily injury" or "property damage" expected or intended from the standpoint of the insured. This exclusion does not apply to "bodily injury" or "property damage" resulting from the use of reasonable force to protect persons or property.

**Q. WAIVER OF TRANSFER OF RIGHTS OF RECOVERY AGAINST OTHERS TO US - WHEN REQUIRED IN A CONTRACT OR AGREEMENT WITH YOU**

Under **Section IV - Commercial General Liability Conditions**, the following is added to **Condition 8. Transfer Of Rights Of Recovery Against Others To Us**:

We waive any right of recovery we may have against a person or organization because of payments we make for injury or damage arising out of your ongoing operations or "your work" done under a contract with that person or organization and included in the "products-completed operations hazard" provided:

1. You and that person or organization have agreed in writing in a contract or agreement that you waive such rights against that person or organization; and
2. The injury or damage occurs subsequent to the execution of the written contract or written agreement.

**THIS ENDORSEMENT CHANGES THE POLICY. PLEASE READ IT CAREFULLY.**

**AMENDMENT OF CANCELLATION PROVISIONS**

This endorsement modifies insurance provided under the following:

**COMMERCIAL GENERAL LIABILITY COVERAGE PART**

Any term or provision of the Cancellation Conditions of the policy or any endorsement amending or replacing such Conditions is amended by the following:

If you have agreed in a written contract or written agreement to provide a person or organization notice of cancellation we agree to the following:

Provide 30 days prior written cancellation notice to such person or organization for reasons other than nonpayment of premium, but only if we are provided with a schedule of persons or organizations with whom you have agreed to provide notification more than 30 days before the cancellation is to take effect.

For purposes of this endorsement, knowledge of the agent as to the persons or organizations requesting notice of cancellation is insufficient to invoke our duty to provide notice of cancellation unless the identity of the persons or organizations is provided directly to us in accordance with the terms of this endorsement.

Failure to provide notice to a person or organization in accordance with the terms of this endorsement shall not extend the effective date of the cancellation or otherwise affect cancellation of the policy as to any insured.



THIS ENDORSEMENT CHANGES THE POLICY. PLEASE READ IT CAREFULLY.

**BUSINESS AUTO COVERAGE ENHANCEMENT ENDORSEMENT**

This endorsement modifies insurance provided under the following:

BUSINESS AUTO COVERAGE FORM

With respect to coverage afforded by this endorsement, the provisions of the policy apply unless modified by the endorsement.

COVERAGE INDEX

SUBJECT	PROVISION NUMBER
ADDITIONAL INSURED BY CONTRACT, AGREEMENT OR PERMIT	3
ACCIDENTAL AIRBAG DEPLOYMENT	12
AMENDED DUTIES IN THE EVENT OF ACCIDENT, CLAIM, SUIT OR LOSS	19
AMENDED FELLOW EMPLOYEE EXCLUSION	5
AUDIO, VISUAL AND DATA ELECTRONIC EQUIPMENT COVERAGE	13
BROAD FORM INSURED	1
BODILY INJURY REDEFINED	22
EMPLOYEES AS INSURED (including employee hired auto)	2
EXTENDED CANCELLATION CONDITION	23
EXTRA EXPENSE - BROADENED COVERAGE	10
GLASS REPAIR - WAIVER OF DEDUCTIBLE	15
HIRED AUTO PHYSICAL DAMAGE (including employee hired auto and loss of use)	6
HIRED AUTO COVERAGE TERRITORY	20
LOAN / LEASE GAP	14
PARKED AUTO COLLISION COVERAGE (WAIVER OF DEDUCTIBLE)	16
PERSONAL EFFECTS COVERAGE	11
PHYSICAL DAMAGE - ADDITIONAL TRANSPORTATION EXPENSE COVERAGE	8
RENTAL REIMBURSEMENT	9
SUPPLEMENTARY PAYMENTS	4
TOWING AND LABOR	7
TWO OR MORE DEDUCTIBLES	17
UNINTENTIONAL FAILURE TO DISCLOSE HAZARDS	18
WAIVER OF TRANSFER OF RIGHTS OF RECOVERY AGAINST OTHERS TO US	20

SECTION II - LIABILITY COVERAGE is amended as follows:

1. BROAD FORM INSURED

SECTION II - LIABILITY COVERAGE, paragraph A.1. - WHO IS AN INSURED is amended to include the following as an insured:

- d. Any legally incorporated entity of which you own more than 50 percent of the voting stock during the policy period. However, "insured" does not include any organization that:
- (1) Is a partnership or joint venture; or
  - (2) Is an insured under any other automobile policy; or
  - (3) Has exhausted its Limit of Insurance under any other automobile policy.
- Paragraph d. (2) of this provision does not apply to a policy written to apply specifically in excess of this policy.
- e. Any organization you newly acquire or form, other than a partnership or joint venture, of which you own more than 50 percent of the voting stock. This automatic coverage is afforded only for 180 days from the date of acquisition or formation. However, coverage under this provision does not apply:
- (1) If there is similar insurance or a self-insured retention plan available to that organization;

- (2) If the Limits of Insurance of any other insurance policy have been exhausted; or
- (3) To "bodily injury" or "property damage" that occurred before you acquired or formed the organization.

## 2. EMPLOYEES AS INSURED

SECTION II - LIABILITY COVERAGE, paragraph A.1. - WHO IS AN INSURED is amended to include the following as an insured:

- f. Any "employee" of yours while using a covered "auto" you do not own, hire or borrow, but only for acts within the scope of their employment by you. Insurance provided by this endorsement is excess over any other insurance available to any "employee".
- g. An "employee" of yours while operating an "auto" hired or borrowed under a written contract or agreement in that "employee's" name, with your permission, while performing duties related to the conduct of your business and within the scope of their employment. Insurance provided by this endorsement is excess over any other insurance available to the "employee".

## 3. ADDITIONAL INSURED BY CONTRACT, AGREEMENT OR PERMIT

SECTION II - LIABILITY COVERAGE, paragraph A.1. - WHO IS AN INSURED is amended to include the following as an insured:

- h. Any person or organization with respect to the operation, maintenance or use of a covered "auto", provided that you and such person or organization have agreed in a written contract, agreement, or permit issued to you by governmental or public authority, to add such person, or organization, or governmental or public authority to this policy as an "insured".

However, such person or organization is an "insured":

- (1) Only with respect to the operation, maintenance or use of a covered "auto";
- (2) Only for "bodily injury" or "property damage" caused by an "accident" which takes place after you executed the written contract or agreement, or the permit has been issued to you; and
- (3) Only for the duration of that contract, agreement or permit

## 4. SUPPLEMENTARY PAYMENTS

SECTION II - LIABILITY COVERAGE, Coverage Extensions, 2.a. Supplementary Payments, paragraphs (2) and (4) are replaced by the following:

- (2) Up to \$3,000 for cost of bail bonds (including bonds for related traffic violations ) required because of an "accident" we cover. We do not have to furnish these bonds.
- (4) All reasonable expenses incurred by the insured at our request, including actual loss of earnings up to \$500 a day because of time off from work.

## 5. AMENDED FELLOW EMPLOYEE EXCLUSION

In those jurisdictions where, by law, fellow employees are not entitled to the protection afforded to the employer by the workers compensation exclusivity rule, or similar protection, the following provision is added:

SECTION II - LIABILITY, exclusion B.5. FELLOW EMPLOYEE does not apply if the "bodily injury" results from the use of a covered "auto" you own or hire.

**SECTION III - PHYSICAL DAMAGE COVERAGE** is amended as follows:

## 6. HIRED AUTO PHYSICAL DAMAGE

Paragraph A.4. Coverage Extensions of SECTION III - PHYSICAL DAMAGE COVERAGE, is amended by adding the following:

If hired "autos" are covered "autos" for Liability Coverage, and if Comprehensive, Specified Causes of Loss or Collision coverage are provided under the Business Auto Coverage Form for any "auto" you own, then the Physical Damage coverages provided are extended to "autos":

- a. You hire, rent or borrow; or

- b. Your "employee" hires or rents under a written contract or agreement in that "employee's" name, but only if the damage occurs while the vehicle is being used in the conduct of your business,

subject to the following limit and deductible:

- A. The most we will pay for "loss" in any one "accident" or "loss" is the smallest of:
- (1) \$50,000; or
  - (2) The actual cash value of the damaged or stolen property as of the time of the "loss"; or
  - (3) The cost of repairing or replacing the damaged or stolen property with other property of like kind and quality, minus a deductible.
- B. The deductible will be equal to the largest deductible applicable to any owned "auto" for that coverage.
- C. Subject to the limit, deductible and excess provisions described in this provision, we will provide coverage equal to the broadest coverage applicable to any covered "auto" you own.
- D. Subject to a maximum of \$1,000 per "accident", we will also cover the actual loss of use of the hired "auto" if it results from an "accident", you are legally liable and the lessor incurs an actual financial loss.
- E. This coverage extension does not apply to:
- (1) Any "auto" that is hired, rented or borrowed with a driver; or
  - (2) Any "auto" that is hired, rented or borrowed from your "employee".

For the purposes of this provision, SECTION V - DEFINITIONS is amended by adding the following: "Total loss" means a "loss" in which the cost of repairs plus the salvage value exceeds the actual cash value.

## 7. TOWING AND LABOR

SECTION III - PHYSICAL DAMAGE COVERAGE, paragraph A.2. Towing, is amended by the addition of the following:

We will pay towing and labor costs incurred, up to the limits shown below, each time a covered "auto" classified and rated as a private passenger type, "light truck" or "medium truck" is disabled:

- a. For private passenger type vehicles, we will pay up to \$50 per disablement.
- b. For "light trucks", we will pay up to \$50 per disablement. "Light trucks" are trucks that have a gross vehicle weight (GVW) of 10,000 pounds or less.
- c. For "medium trucks", we will pay up to \$150 per disablement. "Medium trucks" are trucks that have a gross vehicle weight (GVW) of 10,001 - 20,000 pounds.

However, the labor must be performed at the place of disablement.

## 8. PHYSICAL DAMAGE - ADDITIONAL TRANSPORTATION EXPENSE COVERAGE

Paragraph A.4.a., Coverage Extension of SECTION III - PHYSICAL DAMAGE COVERAGE, is amended to provide a limit of \$50 per day and a maximum limit of \$1,500

## 9. RENTAL REIMBURSEMENT

SECTION III - PHYSICAL DAMAGE COVERAGE, **A. COVERAGE**, is amended by adding the following:

- a. We will pay up to \$75 per day for rental reimbursement expenses incurred by you for the rental of an "auto" because of "accident" or "loss", to an "auto" for which we also pay a "loss" under Comprehensive, Specified Causes of Loss or Collision Coverages. We will pay only for those expenses incurred after the first 24 hours following the "accident" or "loss" to the covered "auto."
- b. Rental Reimbursement will be based on the rental of a comparable vehicle, which in many cases may be substantially less than \$75 per day, and will only be allowed for the period of time it should take to repair or replace the vehicle with reasonable speed and similar quality, up to a maximum of 30 days.
- c. We will also pay up to \$500 for reasonable and necessary expenses incurred by you to remove and replace your tools and equipment from the covered "auto".
- d. This coverage does not apply unless you have a business necessity that other "autos" available for your use and operation cannot fill.
- e. If "loss" results from the total theft of a covered "auto" of the private passenger type, we will pay under this coverage only that amount of your rental reimbursement expenses which is not already provided under Paragraph 4. Coverage Extension.
- f. No deductible applies to this coverage.

For the purposes of this endorsement provision, materials and equipment do not include "personal effects" as defined in provision 11.

## 10. EXTRA EXPENSE - BROADENED COVERAGE

Under SECTION III - PHYSICAL DAMAGE COVERAGE, **A. COVERAGE**, we will pay for the expense of returning a stolen covered "auto" to you. The maximum amount we will pay is \$1,000.

## 11. PERSONAL EFFECTS COVERAGE

- A. SECTION III - PHYSICAL DAMAGE COVERAGE, A. COVERAGE**, is amended by adding the following:

If you have purchased Comprehensive Coverage on this policy for an "auto" you own and that "auto" is stolen, we will pay, without application of a deductible, up to \$600 for "personal effects" stolen with the "auto."

The insurance provided under this provision is excess over any other collectible insurance.

- B. SECTION V - DEFINITIONS** is amended by adding the following:

For the purposes of this provision, "personal effects" mean tangible property that is worn or carried by an insured." "Personal effects" does not include tools, equipment, jewelry, money or securities.

## 12. ACCIDENTAL AIRBAG DEPLOYMENT

SECTION III - PHYSICAL DAMAGE COVERAGE, **B. EXCLUSIONS** is amended by adding the following:

If you have purchased Comprehensive or Collision Coverage under this policy, the exclusion for "loss" relating to mechanical breakdown does not apply to the accidental discharge of an airbag.

Any insurance we provide shall be excess over any other collectible insurance or reimbursement by manufacturer's warranty. However, we agree to pay any deductible applicable to the other coverage or warranty.

## 13. AUDIO, VISUAL AND DATA ELECTRONIC EQUIPMENT COVERAGE

SECTION III - PHYSICAL DAMAGE COVERAGE, **B. EXCLUSIONS**, exception paragraph **a.** to exclusions **4.c.** and **4.d.** is deleted and replaced with the following:

Exclusion **4.c.** and **4.d.** do not apply to:

- a. Electronic equipment that receives or transmits audio, visual or data signals, whether or not designed solely for the reproduction of sound, if the equipment is permanently installed in the covered "auto" at the time of the "loss" and such equipment is designed to be solely operated by use of the power from the "auto's" electrical system, in or upon the covered "auto" and physical damage coverages are provided for the covered "auto"; or

If the "loss" occurs solely to audio, visual or data electronic equipment or accessories used with this equipment, then our obligation to pay for, repair, return or replace damaged or stolen property will be reduced by a \$100 deductible.

#### **14. LOAN / LEASE GAP COVERAGE**

- A. Paragraph **C.**, LIMIT OF INSURANCE of SECTION III - PHYSICAL DAMAGE COVERAGE is amended by adding the following:

The most we will pay for a "total loss" to a covered "auto" owned by or leased to you in any one "accident" is the greater of the:

1. Balance due under the terms of the loan or lease to which the damaged covered "auto" is subject at the time of the "loss" less the amount of:
  - a. Overdue payments and financial penalties associated with those payments as of the date of the "loss",
  - b. Financial penalties imposed under a lease due to high mileage, excessive use or abnormal wear and tear,
  - c. Costs for extended warranties, Credit Life Insurance, Health, Accident or Disability Insurance purchased with the loan or lease,
  - d. Transfer or rollover balances from previous loans or leases,
  - e. Final payment due under a "Balloon Loan",
  - f. The dollar amount of any unrepaired damage which occurred prior to the "total loss" of a covered "auto",
  - g. Security deposits not refunded by a lessor,
  - h. All refunds payable or paid to you as a result of the early termination of a lease agreement or as a result of the early termination of any warranty or extended service agreement on a covered "auto",
  - i. Any amount representing taxes,
  - j. Loan or lease termination fees; or

2. The actual cash value of the damage or stolen property as of the time of the "loss".

An adjustment for depreciation and physical condition will be made in determining the actual cash value at the time of the "loss". This adjustment is not applicable in Texas.

- B. **ADDITIONAL CONDITIONS**

This coverage applies only to the original loan for which the covered "auto" that incurred the loss serves as collateral, or lease written on the covered "auto" that incurred the loss.

- C. **SECTION V - DEFINITIONS** is changed by adding the following:

As used in this endorsement provision, the following definitions apply:

"Total loss" means a "loss" in which the cost of repairs plus the salvage value exceeds the actual cash value.

A "balloon loan" is one with periodic payments that are insufficient to repay the balance over the term of the loan, thereby requiring a large final payment.

#### 15. GLASS REPAIR - WAIVER OF DEDUCTIBLE

Paragraph **D. Deductible** of SECTION III - PHYSICAL DAMAGE COVERAGE is amended by the addition of the following:

No deductible applies to glass damage if the glass is repaired rather than replaced.

#### 16. PARKED AUTO COLLISION COVERAGE (WAIVER OF DEDUCTIBLE)

Paragraph **D. Deductible** of SECTION III - PHYSICAL DAMAGE COVERAGE is amended by the addition of the following:

The deductible does not apply to "loss" caused by collision to such covered "auto" of the private passenger type or light weight truck with a gross vehicle weight of 10,000 lbs. or less as defined by the manufacturer as maximum loaded weight the "auto" is designed to carry while it is:

- a. In the charge of an "insured";
- b. Legally parked; and
- c. Unoccupied.

The "loss" must be reported to the police authorities within 24 hours of known damage.

The total amount of the damage to the covered "auto" must exceed the deductible shown in the Declarations.

This provision does not apply to any "loss" if the covered "auto" is in the charge of any person or organization engaged in the automobile business.

#### 17. TWO OR MORE DEDUCTIBLES

Under SECTION III PHYSICAL DAMAGE COVERAGE, if two or more company policies or coverage forms apply to the same accident, the following applies to paragraph D. Deductible:

- a. If the applicable Business Auto deductible is the smaller (or smallest) deductible it will be waived; or
- b. If the applicable Business Auto deductible is not the smaller (or smallest) deductible it will be reduced by the amount of the smaller (or smallest) deductible; or
- c. If the loss involves two or more Business Auto coverage forms or policies the smaller (or smallest) deductible will be waived.

For the purpose of this endorsement company means any company that is part of the Liberty Mutual Group.

#### SECTION IV - BUSINESS AUTO CONDITIONS is amended as follows:

##### 18. UNINTENTIONAL FAILURE TO DISCLOSE HAZARDS

SECTION IV- BUSINESS AUTO CONDITIONS, Paragraph **B.2.** is amended by adding the following:

If you unintentionally fail to disclose any hazards, exposures or material facts existing as of the inception date or renewal date of the Business Auto Coverage Form, the coverage afforded by this policy will not be prejudiced.

However, you must report the undisclosed hazard of exposure as soon as practicable after its discovery, and we have the right to collect additional premium for any such hazard or exposure.

##### 19. AMENDED DUTIES IN THE EVENT OF ACCIDENT, CLAIM, SUIT, OR LOSS

SECTION IV - BUSINESS AUTO CONDITIONS, paragraph **A.2.a.** is replaced in its entirety by the following:

- a. In the event of "accident", claim, "suit" or "loss", you must promptly notify us when it is known to:
  - 1. You, if you are an individual;
  - 2. A partner, if you are a partnership;
  - 3. Member, if you are a limited liability company;
  - 4. An executive officer or the "employee" designated by the Named Insured to give such notice, if you are a corporation.



To the extent possible, notice to us should include:

- (1) How, when and where the "accident" or "loss" took place;
- (2) The "insureds" name and address; and
- (3) The names and addresses of any injured persons and witnesses.

## **20. WAIVER OF TRANSFER OF RIGHTS OF RECOVERY AGAINST OTHERS TO US**

SECTION IV - BUSINESS AUTO CONDITIONS, paragraph **A.5.**, Transfer of Rights of Recovery Against Others to Us, is amended by the addition of the following:

If the person or organization has waived those rights before an "accident" or "loss", our rights are waived also.

## **21. HIRED AUTO COVERAGE TERRITORY**

SECTION IV - BUSINESS AUTO CONDITIONS, paragraph **B.7.**, Policy Period, Coverage Territory, is amended by the addition of the following:

- f. For "autos" hired 30 days or less, the coverage territory is anywhere in the world, provided that the insured's responsibility to pay for damages is determined in a "suit", on the merits, in the United States, the territories and possessions of the United States of America, Puerto Rico or Canada or in a settlement we agree to.

This extension of coverage does not apply to an "auto" hired, leased, rented or borrowed with a driver.

## **SECTION V - DEFINITIONS is amended as follows:**

### **22. BODILY INJURY REDEFINED**

Under SECTION V - DEFINITIONS, definition **C.** is replaced by the following:

"Bodily injury" means physical injury, sickness or disease sustained by a person, including mental anguish, mental injury, shock, fright or death resulting from any of these at any time.

## **COMMON POLICY CONDITIONS**

### **23. EXTENDED CANCELLATION CONDITION**

COMMON POLICY CONDITIONS, paragraph **A.** - CANCELLATION condition applies except as follows:

If we cancel for any reason other than nonpayment of premium, we will mail to the first Named Insured written notice of cancellation at least 60 days before the effective date of cancellation. This provision does not apply in those states which require more than 60 days prior notice of cancellation.

**THIS ENDORSEMENT CHANGES THE POLICY. PLEASE READ IT CAREFULLY.**

## **DESIGNATED INSURED**

This endorsement modifies insurance provided under the following:

BUSINESS AUTO COVERAGE FORM  
GARAGE COVERAGE FORM  
MOTOR CARRIER COVERAGE FORM  
TRUCKERS COVERAGE FORM

With respect to coverage provided by this endorsement, the provisions of the Coverage Form apply unless modified by this endorsement.

This endorsement identifies person(s) or organization(s) who are "insureds" under the Who Is An Insured Provision of the Coverage Form. This endorsement does not alter coverage provided in the Coverage Form.

This endorsement changes the policy effective on the inception date of the policy unless another date is indicated below.

Effective Date: **12/4/2019**

Named Insured: CSG Consultants, Inc.; Precision Inspection-CSG

### **SCHEDULE**

Name of Person(s) or Organization(s): as required by written contract

(If no entry appears above, information required to complete this endorsement will be shown in the Declarations as applicable to the endorsement.)

Each person or organization shown in the Schedule is an "insured" for Liability Coverage, but only to the extent that person or organization qualifies as an "insured" under the Who Is An Insured Provision contained in **Section II** of the Coverage Form.

**THIS ENDORSEMENT CHANGES THE POLICY. PLEASE READ IT CAREFULLY.**

**DESIGNATED INSURED – NONCONTRIBUTING**

This endorsement modifies insurance provided under the following:

BUSINESS AUTO COVERAGE FORM  
GARAGE COVERAGE FORM  
MOTOR CARRIER COVERAGE FORM  
TRUCKERS COVERAGE FORM

With respect to coverage provided by this endorsement, the provisions of the Coverage Form apply unless modified by this endorsement.

This endorsement identifies person(s) or organization(s) who are "insureds" under the Who Is An Insured Provision of the Coverage Form. This endorsement does not alter coverage provided in the Coverage Form.

**Schedule**

**Name of Person(s) or Organization(s):** Any entity with respect to a covered "auto" provided that you and such entity have agreed in a written contract, agreement, or permit to add such entity as an "insured".

**Regarding Designated Contract or Project:** N/A

Each person or organization shown in the Schedule of this endorsement is an "insured" for Liability Coverage, but only to the extent that person or organization qualifies as an "insured" under the Who Is An Insured Provision contained in Section II of the Coverage Form.

**The following is added to the Other Insurance Condition:**

If you have agreed in a written agreement that this policy will be primary and without right of contribution from any insurance in force for an Additional Insured for liability arising out of your operations, and the agreement was executed prior to the "bodily injury" or "property damage", then this insurance will be primary and we will not seek contribution from such insurance.

**THIS ENDORSEMENT CHANGES THE POLICY. PLEASE READ IT CAREFULLY.**

**AMENDMENT OF CANCELLATION PROVISIONS**

This endorsement modifies insurance provided under the following:

BUSINESS AUTO COVERAGE FORM  
MOTOR CARRIER COVERAGE FORM  
GARAGE COVERAGE FORM

With respect to coverage provided by this endorsement, the provisions of the policy apply unless modified by this endorsement.

Any term or provision of the Cancellation Conditions of the policy or any endorsement emending or replacing such Conditions is amended by the following:

If you have agreed in a written contract or written agreement to provide a person or organization notice of cancellation we agree to the following:

- a. Provide a 30 days prior written cancellation notice to such persons or organization for reasons other than nonpayment of premium, but only if we are provided with a schedule of persons or organizations with whom you have agreed to provide notification more than 30 days before the cancellation is to take effect.

As a condition of this endorsement, you must notify your agent of any written contract or agreement where you have agreed to provide notice of cancellation, other than nonpayment of premium, to a specific person or organization.

Failure to provide to a person or organization in accordance with the terms of this endorsement shall not extend the effective date of the cancellation or otherwise affect cancellation of the policy as to any insured.

**WAIVER OF OUR RIGHT TO RECOVER FROM OTHERS ENDORSEMENT-CALIFORNIA  
BLANKET BASIS**

We have the right to recover our payments from anyone liable for an injury covered by this policy. We will not enforce our right against the person or organization named in the Schedule. (This agreement applies only to the extent that you perform work under a written contract that requires you to obtain this agreement from us.)

The additional premium for this endorsement shall be 2% of the total manual premium otherwise due on such remuneration. The minimum premium for this endorsement is \$350.

This agreement shall not operate directly or indirectly to benefit anyone not named in the Schedule.

**SCHEDULE****BLANKET WAIVER**

<b>Person/Organization</b>	Blanket Waiver – Any person or organization for whom the Named Insured has agreed by written contract to furnish this waiver.
----------------------------	---

<b>Job Description</b>	<b>Waiver Premium</b>
All CA Operations	3196.00

This endorsement changes the policy to which it is attached and is effective on the date issued unless otherwise stated.  
(The information below is required only when this endorsement is issued subsequent to preparation of the policy.)

Endorsement Effective **12/04/2019**Policy No. **CSWC036787**

Endorsement No.

Insured CSG Consultants, Inc.

Premium \$

Insurance Company Redwood Fire And Casualty Insurance



**THIS ENDORSEMENT CHANGES THE POLICY. PLEASE READ IT CAREFULLY.**

**NOTICE OF CANCELLATION – CERTIFICATE HOLDERS  
(SPECIFIED DAYS)**

The person(s) or organization(s) listed or described in the Schedule below have requested that they receive written notice of cancellation when this policy is cancelled by us. We will mail or deliver to the Person(s) or Organization(s) listed or described in the Schedule a copy of the written notice of cancellation that we sent to you. If possible, such copies of the notice will be mailed at least 30 days, except for cancellation for non-payment of premium which will be mailed 10 days, prior to the effective date of the cancellation, to the address or addresses of certificate holders as provided by your broker or agent.

**Schedule**

Person(s) or Organization(s) including mailing address:

All certificate holders where written notice of the cancellation of this policy is required by written contract, permit or agreement with the Named Insured and whose names and addresses will be provided by the broker or agent listed in the Declarations Page of this policy for the purposes of complying with such request.

This notification of cancellation of the policy is intended as a courtesy only. Our failure to provide such notification to the person(s) or organization(s) shown in the Schedule will not extend any policy cancellation date nor impact or negate any cancellation of the policy. This endorsement does not entitle the person(s) or organization(s) listed or described in the Schedule above to any benefit, rights or protection under this policy.

Any provision of this endorsement that is in conflict with a statute or rule is hereby amended to conform to that statute or rule.

All other terms and conditions of this policy remain unchanged.

Endorsement Number: 7

Policy Number: **PAAEP0008804**

Named Insured: CSG Consultants, Inc.

This endorsement is effective on the inception date of this Policy unless otherwise stated herein:

Endorsement Effective Date: **December 4, 2019**