

April 17, 2017

Gian Paolo Martire, Associate Planner  
City of Cupertino  
(408) 777-3319  
[gianm@cupertino.org](mailto:gianm@cupertino.org)  
*Sent via email only*

Subject: Conditional Use Permit for extended business hours at  
Starbucks #5217 (new location)  
21731 Stevens Creek Blvd. | Cupertino, CA | 95104

Dear Mr. Martire,

Please consider this letter as an initial application for a Conditional Use Permit for the above-referenced new Starbucks location. The store is currently in design development and is expected to open in October 2017.

As requested, we present the following for your consideration:

**Starbucks** - Starbucks Corporation is an American coffee company and coffeehouse chain. Starbucks was founded in Seattle, Washington in 1971. As of November 2016, it operates 23,768 locations worldwide, including 13,107 in the United States, 2,204 in China, 1,418 in Canada, 1,160 in Japan and 872 in South Korea.

*Mission*

*To inspire and nurture the human spirit—one person, one cup and one neighborhood at a time.*

*Values*

*With our partners, our coffee and our customers at our core, we live these values:*

- *Creating a culture of warmth and belonging, where everyone is welcome.*
- *Acting with courage, challenging the status quo and finding new ways to grow our company and each other.*
- *Being present, connecting with transparency, dignity and respect.*
- *Delivering our very best in all we do, holding ourselves accountable for results.*

*We are performance driven, through the lens of humanity.*

**Hours of Operation**

The proposed operating hours for this store are 5am to 9pm every day.

For your convenience, here is a table of store hours at existing Starbucks locations in the same area:

20520 Stevens Creek Blvd (Crossroads Shopping Center)	Monday-Sunday: 5:00 am-11:00pm
20745 Stevens Creek Blvd (Target)	Monday-Sunday: 8:30am-9:00pm
22390 Homestead Road	Monday-Sunday: 5:30 am-12:00 am
20676 Homestead Rd (Homestead Square)	Monday-Sunday: 5:00 am-11:00 pm

**Store Data:**

2,584 gross SF

47 seats

**Floor Plan:**

[still in design development]

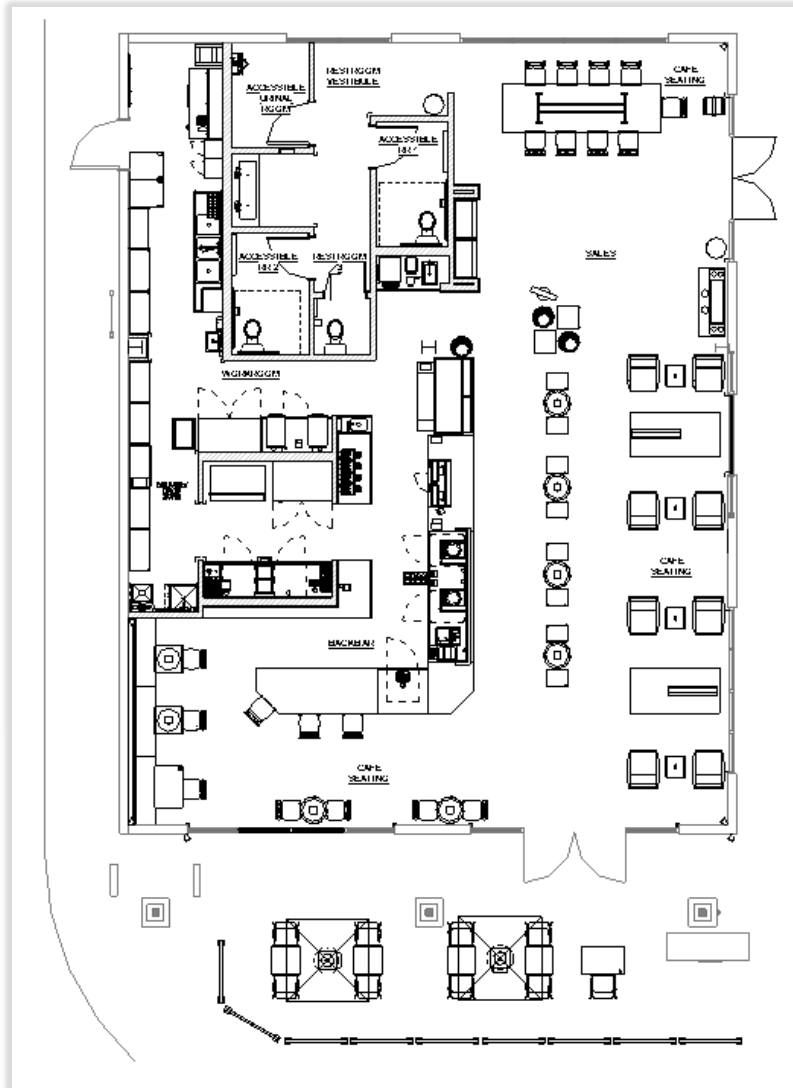

Please advise our next steps in the process of application and approval. Your time and consideration of the presented materials is greatly appreciated.

Sincerely,



**Tamara Shroll**, NCARB, LEED AP, CSI  
Lead Project Architect

Cc: L. Amber Reed, Store Development Manager, Starbucks Coffee Company  
Justine Hewitt, Design Project Manager, Starbucks Coffee Company