

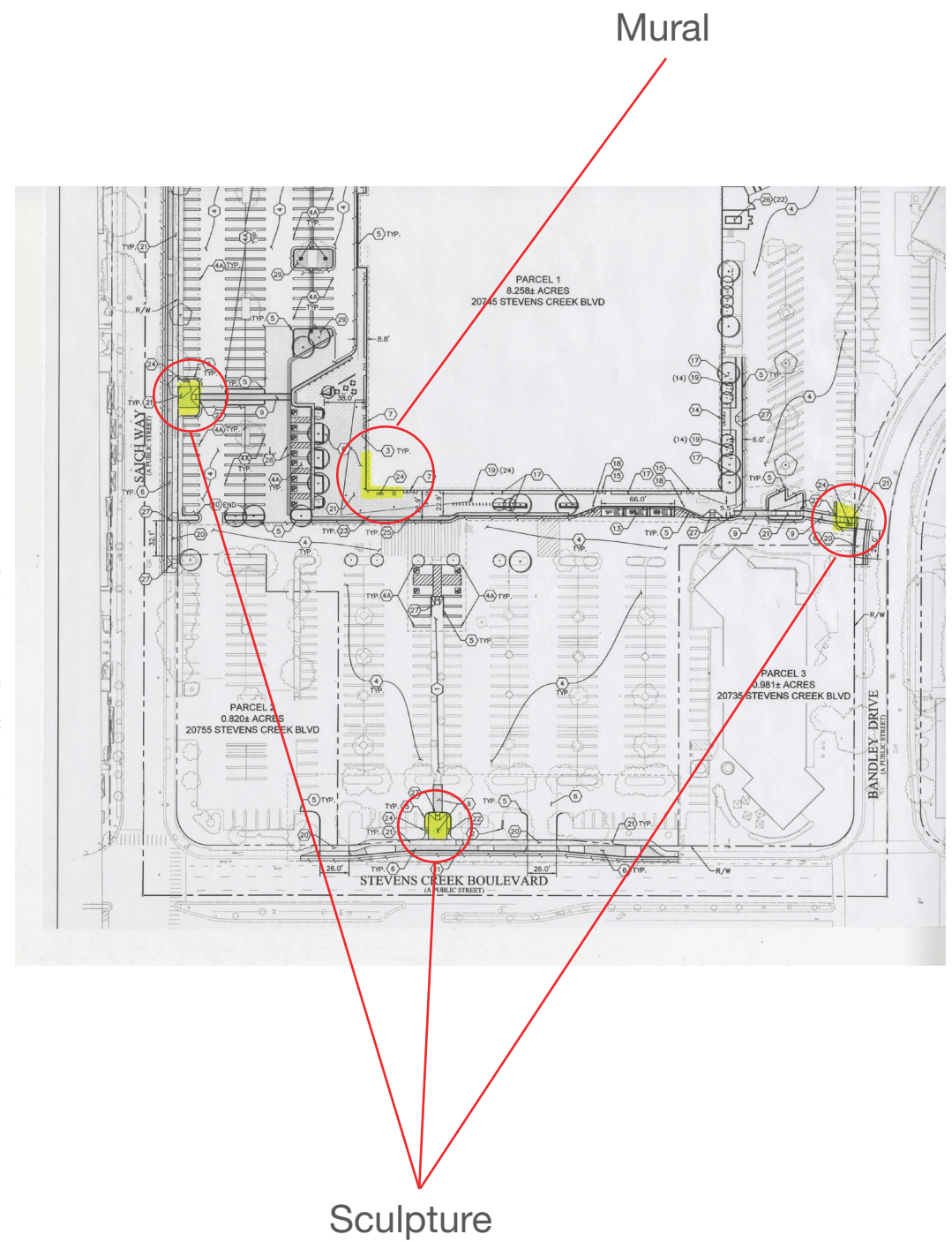

Cupertino  
Local Artist Mural  
April 9, 2018

All information contained is  
strictly confidential.

# Mural and Sculpture Moment Locations



# About the Artist



**Michael Bartalos** has worked extensively in the graphic arts in the U.S., Europe and Japan. His illustration commissions include Swatch watches, stamps for the U.S. Postal Service, and merchandise and display graphics for the California Academy of Sciences. He has partnered with Target over several years in designing numerous gift cards and a variety of marketing collateral.

Bartalos also produces limited print editions and sculptures, and worked with the San Francisco Arts Commission to create “Mission Parade,” a permanent public artwork in the form of a decorative fence surrounding San Francisco’s Mission Playground. He has recently been a grantee of the National Science Foundation’s Antarctic Artists and Writers Program, a Stanford Fellow at SOMA Summer in Mexico City, and a Graduate Fellow at the Headlands Center for the Arts in Sausalito.



Bartalos attended the School of the Art Institute of Chicago, Pratt Institute (BFA), and Stanford University (MFA). He has lived in the Bay Area for 22 years, currently works out of Menlo Park, and is Adjunct Professor of Graduate Design at the California College of the Arts in San Francisco. In addition to making art and teaching, he enjoys biking, running, and traveling with his wife and two sons.

His work is online at <http://bartalosillustration.com>.

# Michael Bartalos Art Examples



**Thank you**

CUPERTINO MURAL: *TREE TOWN*  
NARRATIVE

Michael Bartalos | 2018 May 21

Page 1

Cupertino has an abundance of parks, plants, and wildlife. This mural, titled *Tree Town*, celebrates the natural scenery in and around the city by prominently featuring its trees. As such, it also references Cupertino's early history in fruit agriculture.

The mural's plants and landmarks are labeled on page 3. Many of the trees and cactii will be embellished with line textures to resemble maps and mazes, inviting passersby in for a closer look to discover more detail. Another interactive aspect is the mural's hanging "swing," a stationary bench protruding from the art wall amidst the greenery for visitors to find fun photo-ops in.

*Tree Town* also represents the wide variety of animals that populate Cupertino's parks and gardens. They range from mammals and birds to reptiles and amphibians as labeled on page 4. The animals are shown to be diverse, abundant, interdependent on each other, and central to Cupertino's environment.

In the background between the trees, visitors will find manmade landmarks and points of interest that further identify the location uniquely as Cupertino. These include De Anza College, Memorial Park, Cali Mill Plaza, and City Hall's morion sculpture, among others.

WEST EXTERIOR ELEVATION << | >> SOUTH EXTERIOR ELEVATION



ART WALL 3: West Cupertino

ART WALL 2: Central Cupertino

ART WALL 1: East Cupertino

PLANTS AND LANDMARKS LABELED

WEST EXTERIOR ELEVATION << >> SOUTH EXTERIOR ELEVATION



- Western Yellow Pine
- Rancho San Antonio Open Space Preserve
- Peppermint Willow
- McClellan Ranch Preserve
- Big Leaf Maple
- Sago Palm
- Red Alder
- Wild Mushrooms
- Stevens Creek County Park
- California Buckeye
- Fujitsu Planetarium
- Douglas Fir
- De Anza College

- Cereus Giganteus
- Quaking Aspen
- Giant Chain Fern
- Memorial Park
- Madrone
- School
- Redwood
- Bottle Palm
- Memorial Park
- Redwood
- School
- Quaking Aspen
- Cereus Giganteus

- San Pedro Cactus
- Photo Op "swing"
- Big Leaf Maple
- Sycamore
- Cottonwood

- Apple Infinite Loop Campus
- White Spruce
- Western Sword Fern
- California Fan Palm
- City Hall
- Morion sculpture
- Cali Mill Plaza
- Coast Live Oak

ART WALL 3: West Cupertino

ART WALL 2: Central Cupertino

ART WALL 1: East Cupertino



CUPERTINO MURAL: TREE TOWN

Exterior Wall Mural Elevation

Michael Bartalos | 2018 May 21

Page 4

ANIMALS LABELED

WEST EXTERIOR ELEVATION << >> SOUTH EXTERIOR ELEVATION



- Steller's Jay
- American Robin
- White-crowned Sparrow
- Mallard
- Bullseye
- Great-tailed Grackle
- Cedar Waxwing
- California Quail
- California Mouse
- California Kingsnake
- Great-tailed Grackle

- American Goldfinch
- Chestnut-backed Chickadee
- Lesser Goldfinch
- White Pekin duckling
- Cheshire Cat
- Acorn Woodpecker
- Mitred Conure
- Killdeer flock
- Western Pond Turtle

- American Robin
- Steller's Jay
- Northern Raccoon
- American Bullfrog
- House Finch
- Black Phoebe
- Black Phoebe

- Steller's Jay
- Song Sparrow
- Screech Owls
- California Mouse
- American Robin
- Fox Squirrel
- Steller's Jay

ART WALL 3: West Cupertino

ART WALL 2: Central Cupertino

ART WALL 1: East Cupertino

CUPERTINO MURAL: *TREE TOWN*  
Exterior Wall Mural Perspective  
Michael Bartalos | 2018 May 21



CUPERTINO SCULPTURAL SEATING: *TREE TOWN*  
NARRATIVE

Michael Bartalos | 2018 May 21

Page 6

The *Tree Town* mural is complemented by outdoor sculptural seating. A live tree with a birdhouse serves as the seating unit's centerpiece, referencing the imagery on the nearby art walls and taking the tree theme into a three-dimensional interactive realm. The tree provides shoppers with a shady respite and a touch of nature on Cupertino's busiest thoroughfare.

The surface colors of the seating unit echoes those of the mural and has designs etched into them that play off the mural graphics. The structural core of the unit will likely be steel and the surface material will either match or mimic the art wall's surface material for continuity.

CUPERTINO SCULPTURAL SEATING: *TREE TOWN*  
CONCEPT  
Michael Bartalos | 2018 May 21

Page 7



T3224 Cupertino

# Art Bench Dimensions

