



ILLUSTRATIVE SITE PLAN

10268 BANDLEY DRIVE
Cupertino, California

A0.2



September 24, 2025

0 10 20 40

© 2025 WILLIAM HEZMALHALCH ARCHITECTS, INC. DBA WHA | 2024406

BMR UNIT SUMMARY				ELIGIBLE HOUSEHOLD	
UNIT #	PLAN TYPE	NUMBER OF BEDROOMS	LIVING AREA (SF)	80%-100% OF AMI	100%-120% OF AMI
20, 26	PLAN 1	3	1,507	2	
2	PLAN 1X	4	1,646	1	
5, 17	PLAN 1X	4	1,646		2

BEDROOMS	PROJECT MIX		BMR MIX	
	UNITS	PERCENTAGE	UNITS	PERCENTAGE
3 BEDROOMS	7	26%	2	40%
4 BEDROOMS	20	74%	3	60%
TOTAL	27	100%	5	100%

ELIGIBLE HOUSEHOLD INCOME	UNITS	PERCENTAGE
80% - 100% OF AMI	3	60%
100%-120% OF AMI	2	40%
TOTAL	5	100%

Note: All units are for sale.

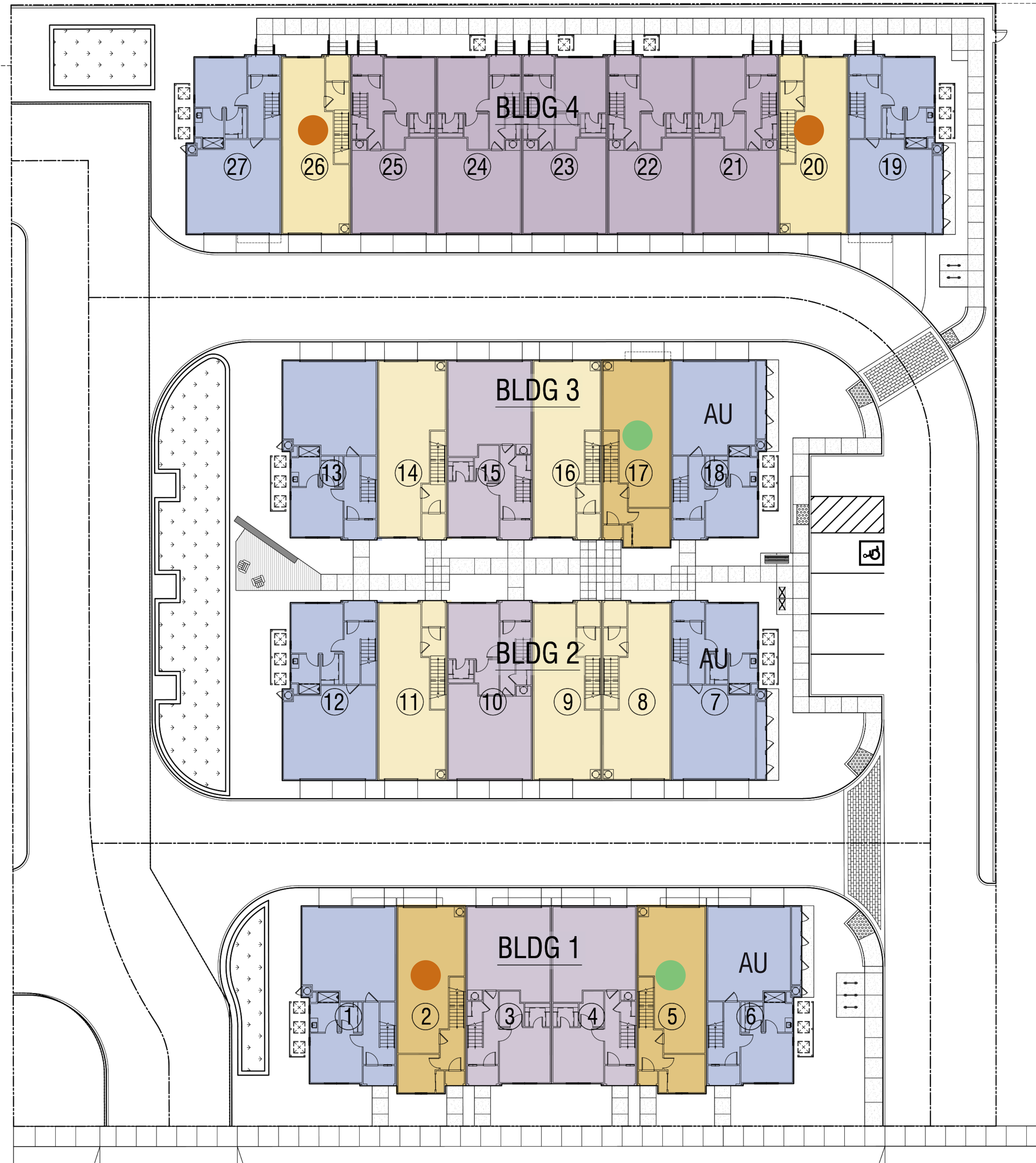

LEGEND:

- (X) UNIT NUMBER
- PLAN 1
- PLAN 1X
- PLAN 2
- PLAN 3
- AU ADAPTABLE
- BMR BELOW-MARKET RATE UNIT
 - Moderate Income
 - Median Income

- Notes:
- Refer to Civil Sheets for all property lines, easements, site dimensions, accessible unit locations, etc.
 - Refer to project data Sheet A0.9 for all site data information
 - Refer to Landscape sheets for landscape design, dimensions and detailed information

ARCHITECTURAL SITE PLAN

10268 BANDLEY DRIVE
Cupertino, California

A0.6



September 24, 2025

0 10 20 40



BANDLY DRIVE - EXISTING SITE



BANDLY DRIVE -PHOTO SIMULATION

STREETSCENE AND PHOTO SIMULATION

10268 BANDLEY DRIVE
Cupertino, California

A0.11



September 24, 2025

0 4 8 16

© 2025 WILLIAM HEZMALHALCH ARCHITECTS, INC. DBA WHA | 2024406

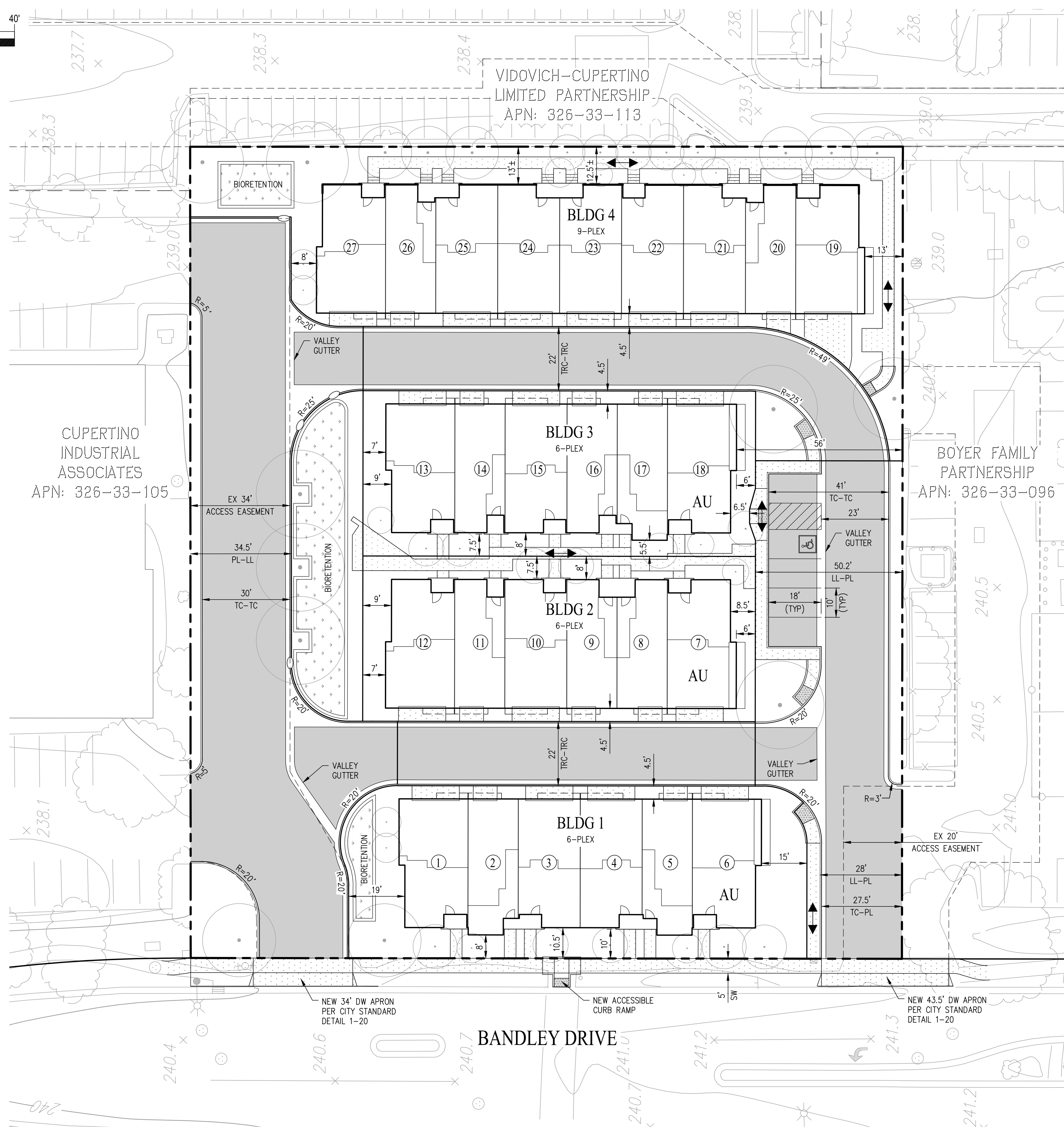
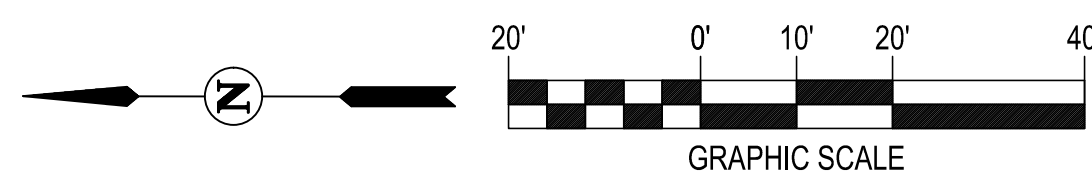

ABBREVIATIONS

- EVCS ELECTRIC VEHICLE CHARGING STATION
- LL LOT LINE
- LS LANDSCAPE
- LSE LANDSCAPE EASEMENT
- RW RIGHT OF WAY
- SW SIDEWALK
- TC TOP OF CURB
- TRC TOP OF ROLLED CURB

LEGEND

- PROPERTY BOUNDARY
- LOT LINE
- RIGHT-OF-WAY
- BLDG 1**
- BUILDING NUMBER
- AU**
- ADAPTABLE UNIT
- ACCESSIBLE PARKING STALL
- ACCESSIBLE PEDESTRIAN PATH OF TRAVEL
- PROPOSED SIDEWALK

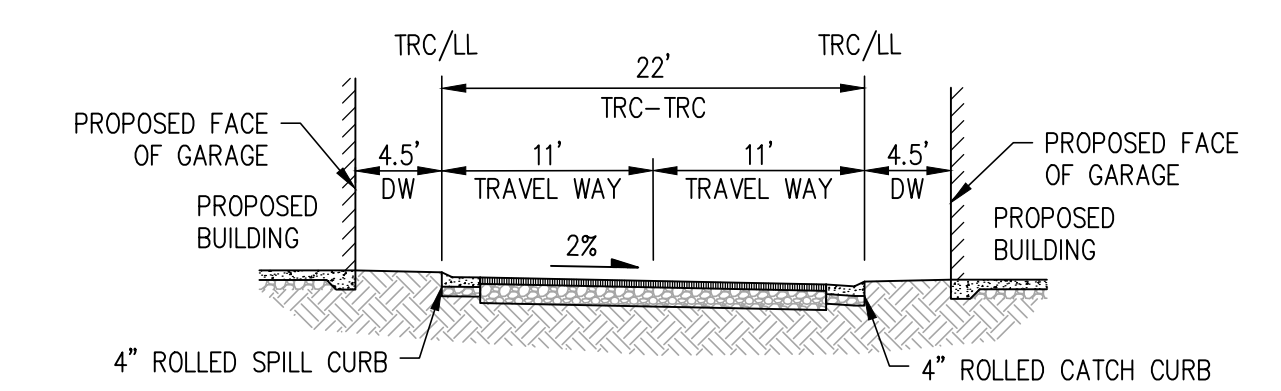

TYPICAL 22' TRC-TRC ALLEY SECTION
NOT TO SCALE

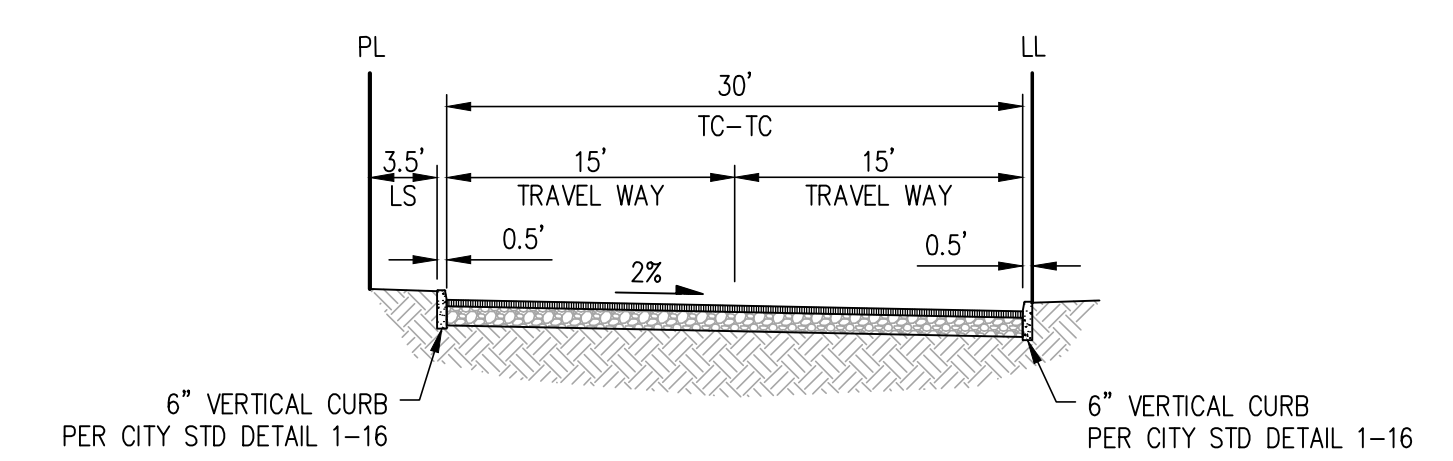

TYPICAL 30' TC-TC STREET SECTION
NOT TO SCALE

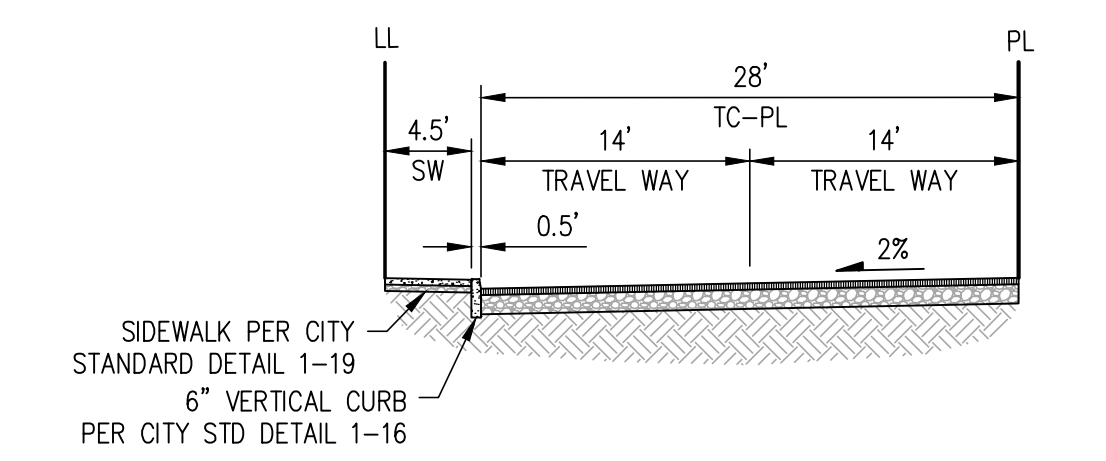

TYPICAL 28' STREET SECTION
NOT TO SCALE

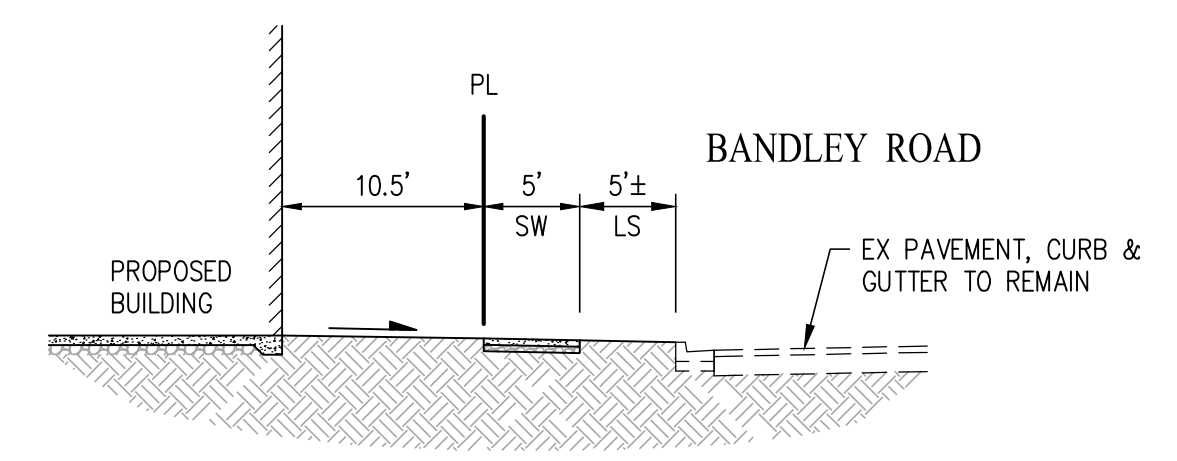

BANDLEY ROAD
NOT TO SCALE

NOTE:
DEVELOPER PROPOSES TO PAY A FEE IN-LIEU OF PROVIDING PUBLIC ART IN ACCORDANCE WITH THE PROJECT DESCRIPTION.